

WINCTRL

WINCTRL 32 AGP Metal 1.0

Model 32.AGP.Met.1.0

User Manual

V1.0 2025.09.29

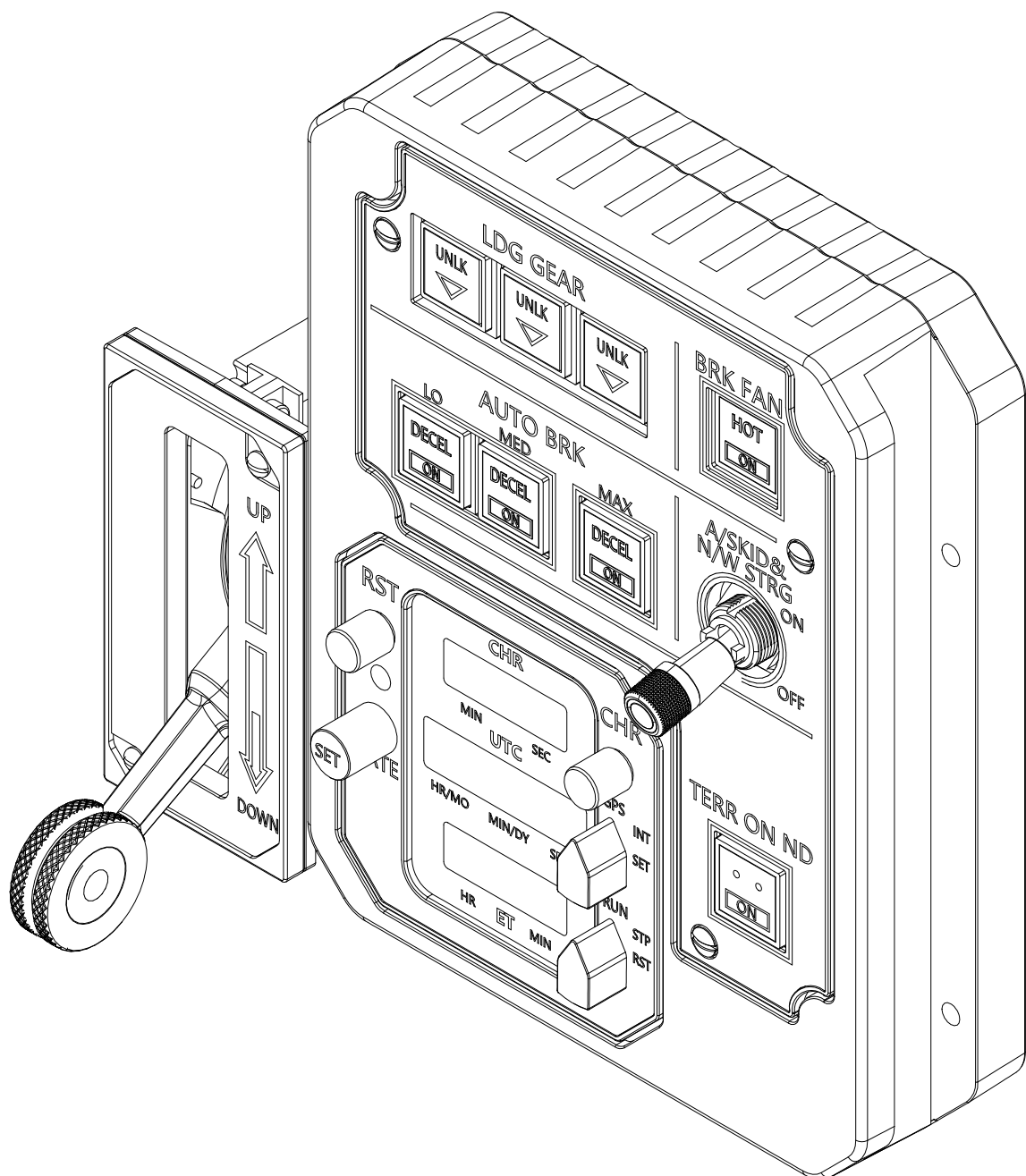

Packing List

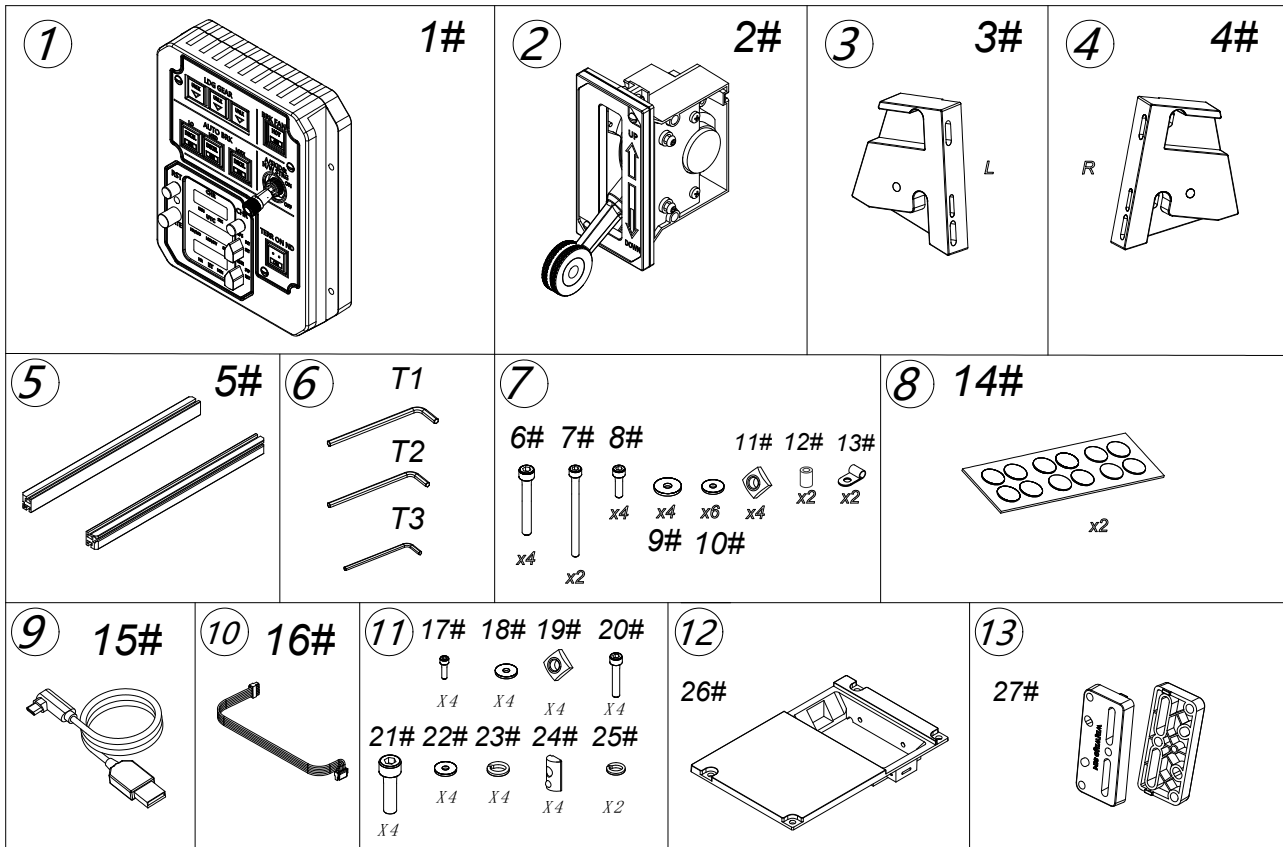

①. 32.AGP.Met.1.0 (1#)	1
②. Landing Gear Module (2#)	1
③. Mounting Bracket2-Left 3 (3#)	1
④. Mounting Bracket2-Right 3 (4#)	1
⑤. Installation Guild Rail (5#)	2
⑥. Tool Kit (T1-T3)	1
⑦. Accessory Kit 1 (6#~13#)	1
6#: Hexagon Socket Cap Screw M5*22;		
7#: Hexagon Socket Cap Screw M4*45;		
8#: Hexagon Socket Cap Screw M4*8;		
9#: Flat Washer M5*10*1;		
10#: Flat Washer M4*7*0.8;		
11#: Square Nut M4*7*3;		
12#: Landing Gear Support Part;		
13#: R Shape Cable Clip UC-0.5 Black;		
⑧. Nano Double Sided Adhesive Dots (14#)	2
⑨. Data Cable (15#)	1
⑩. Landing Gear Connection Cable (16#)	1
⑪. Accessory Kit 2 (17#~25#)	1
17#: Hexagon Socket Cap Screw M3*4;		
18#: Flat Washer M3*8*0.5;		
19#: Square Nut M4*7*3;		
20#: Hexagon Socket Cap Screw M4*16;		
21#: Hexagon Socket Cap Screw M5*28;		
22#: Flat Washer M5*10*1;		
23#: Spring Washer M5;		
24#: Spring Nut 20 EU Standard M5;		

25# Spring Washer M4

⑫. Landing Gear Panel Plate (25#)	1
⑬. Bracket Spacer (26#)	2

Catalog

1. Product Profile	3
1.1 Parts Diagram	3
1.2 Performance Specifications	4
1.3 Product Dimensions	7
1.4 Installation Dimensions	9
1.5 Installation Compatibility	11
2 First Use	11
2.1 Software Installation	11
2.2 Parts Installation	12
2.3 How to Use	15
3 Function	16
3.1 Mechanical and Special Features	16
3.2 Buttons	17
3.3 Data Interface	17
3.4 Adjustment Method	18
4 Installation Methods	20
4.1 Desktop Mounting Method	20
4.1.1 Desktop Mounting Method 1 (recommended for desktop use)	20
4.1.2 Desktop Mounting Method2	24
4.2 Profile Installation ^(*Profile bars and related accessories need to be self-prepared.)	26
4.3 Winctrl Throttle Desk Mount5 Mounting Method(Winctrl Throttle Desk Mount5 is sold separately)	29
4.4 Integrated Device Installation	32
5 Maintenance and Care	35
5.1 Firmware Upgrade	35
5.2 Cleaning and Maintenance	35
5.3 FAQs and After-Sales Service	36
6 Safety Precautions	37

1. Product Profile

1.1 Parts Diagram

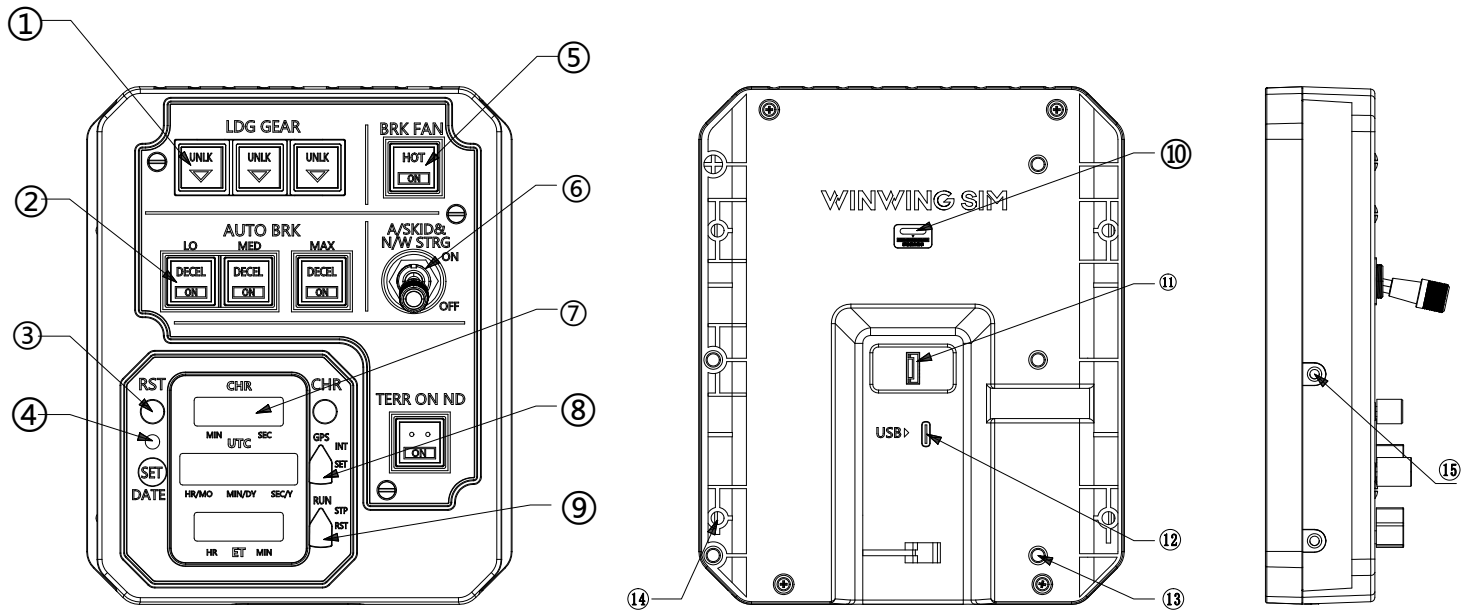

①Indicator Light

③Press Encoder

⑤Latching Switch Press Button

⑦Digital Display

⑨3-Position Auto-Reset Knob

⑪Landing Gear Module Signal Port

⑬Mounting Holes for Brackets

⑮Mounting Holes for Landing Gear

②Press Button

④Light Sensor

⑥2-Position Toggle Switch with Lock

⑧3-Position Knob

⑩LED Indicator

⑫USB Data Port

⑭Mounting Holes for Profiles

1.2 Performance Specifications

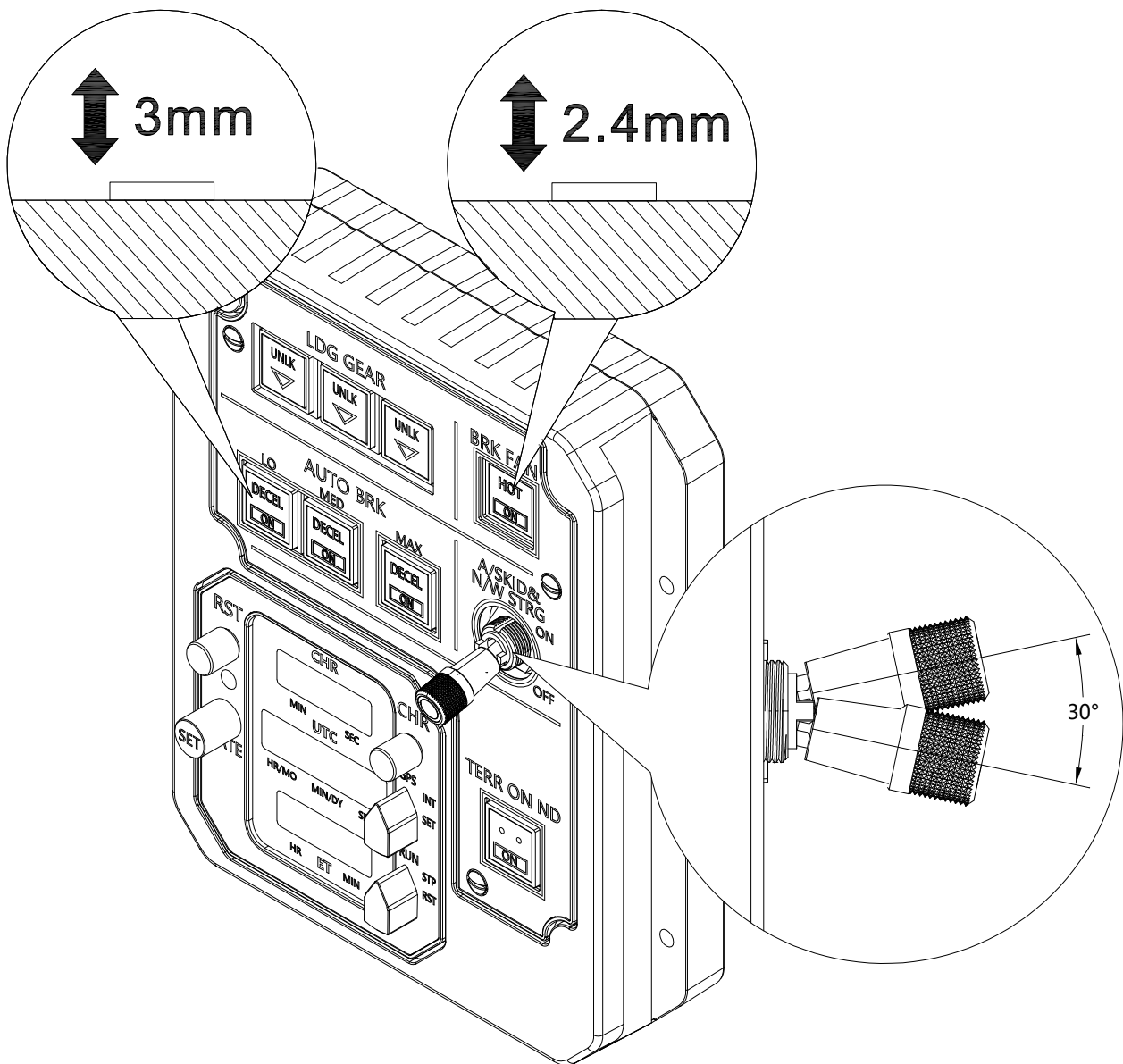

1.2.1 Four press buttons, with travel of 3mm.

1.2.2 One latching switch press button ,with travel of 2.4mm.

1.2.3 One toggle switch with lock, with travel of 30° .

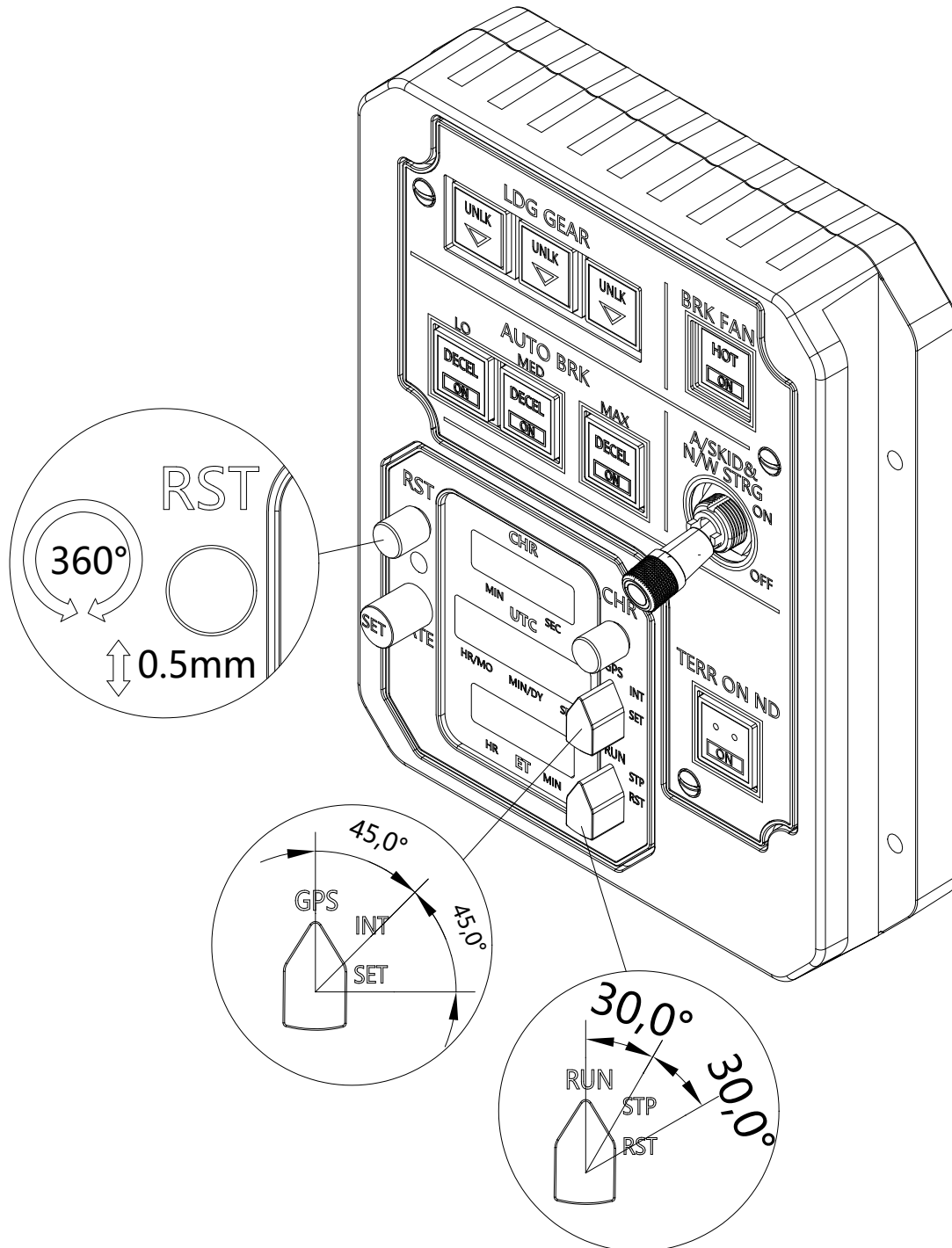

1.2.4 Three pressable knobs with rotation angle of 360° , press travel of 0.5mm.

*NOTE: Rotation and press only, force pull may result in product damage.

1.2.5 One 3-position knob, with rotation angle of 90° , interval of 45° . *NOTE:

Rotation only, force push/pull may result in product damage.

1.2.6 One 3-position auto-reset knob, with rotation angle of 60° , interval of 30° .

*NOTE: Rotation only, force push/pull may result in product damage.

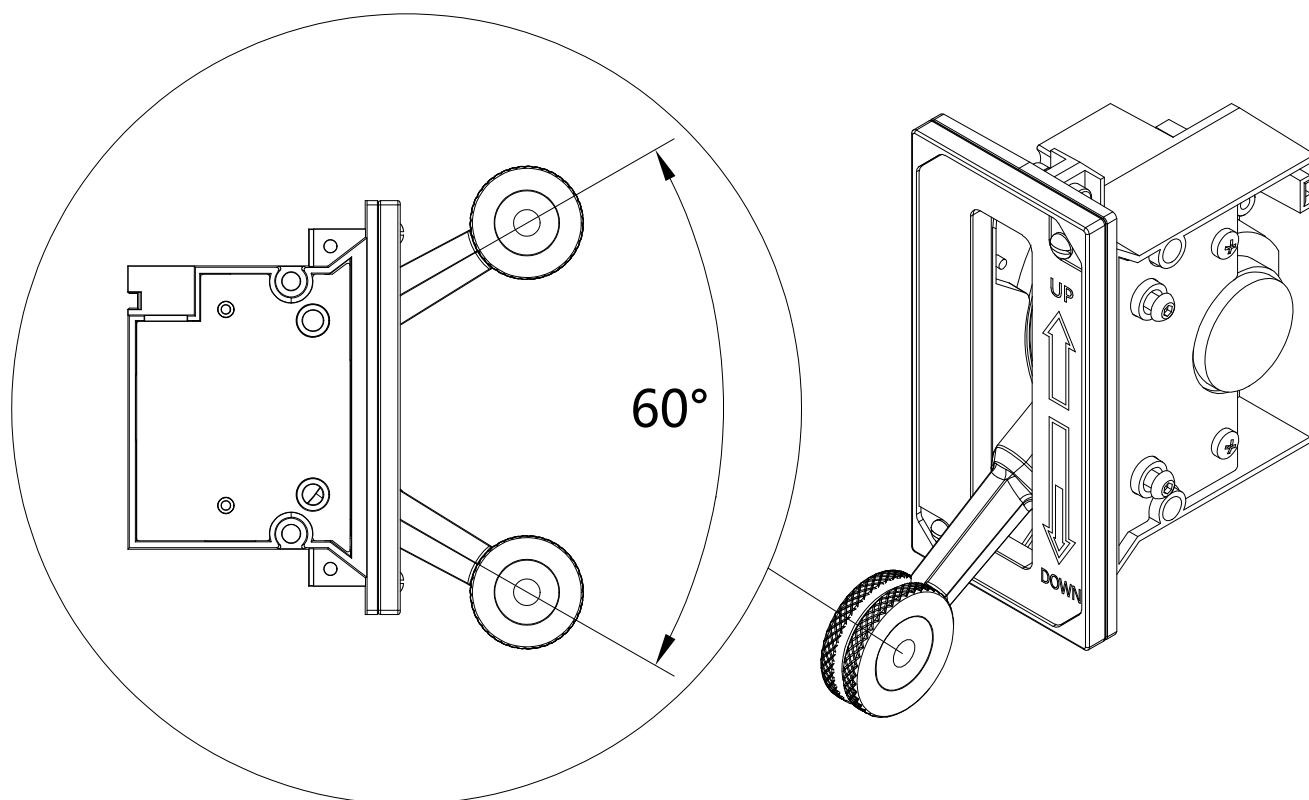

1.2.7 One landing gear handle, with travel angle of 60° . *NOTE: Vertical movement only, forcing it to move sideways may result in product damage.

1.3 Product Dimensions

- LxWxH: 180mm*148mm*38mm; Weight: 0.61 Kg= 1.35 lb

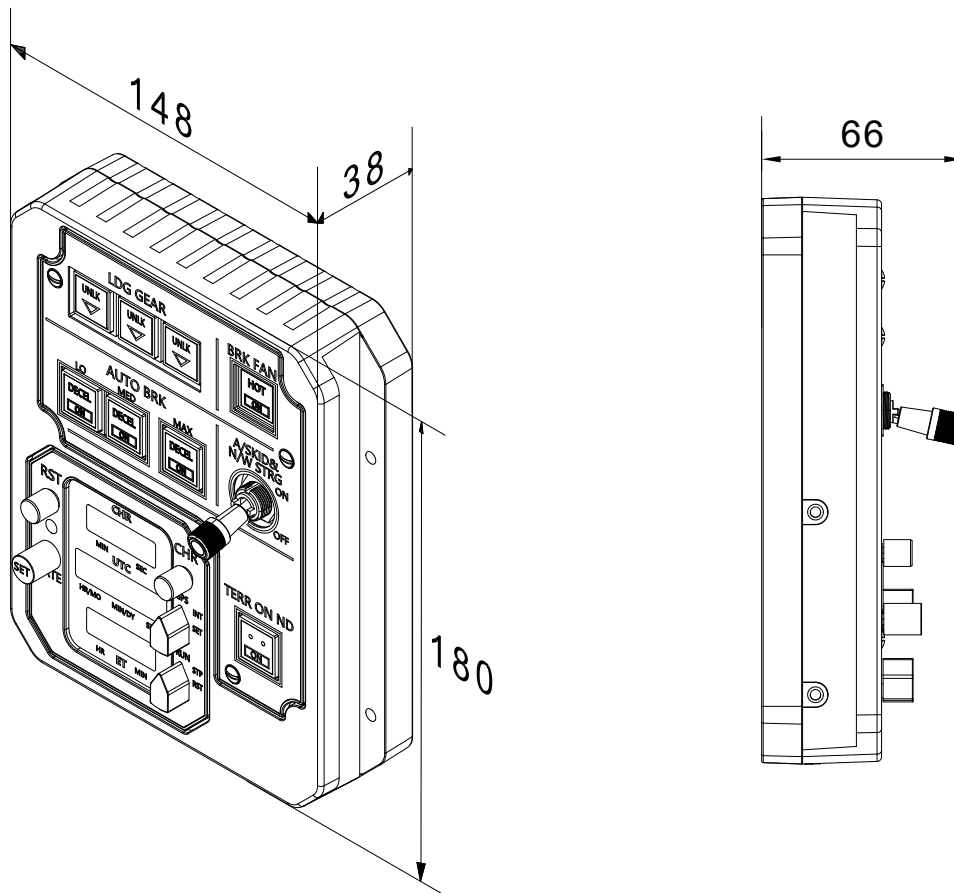

- Landing gear module dimension is 46mm*105mm*95mm

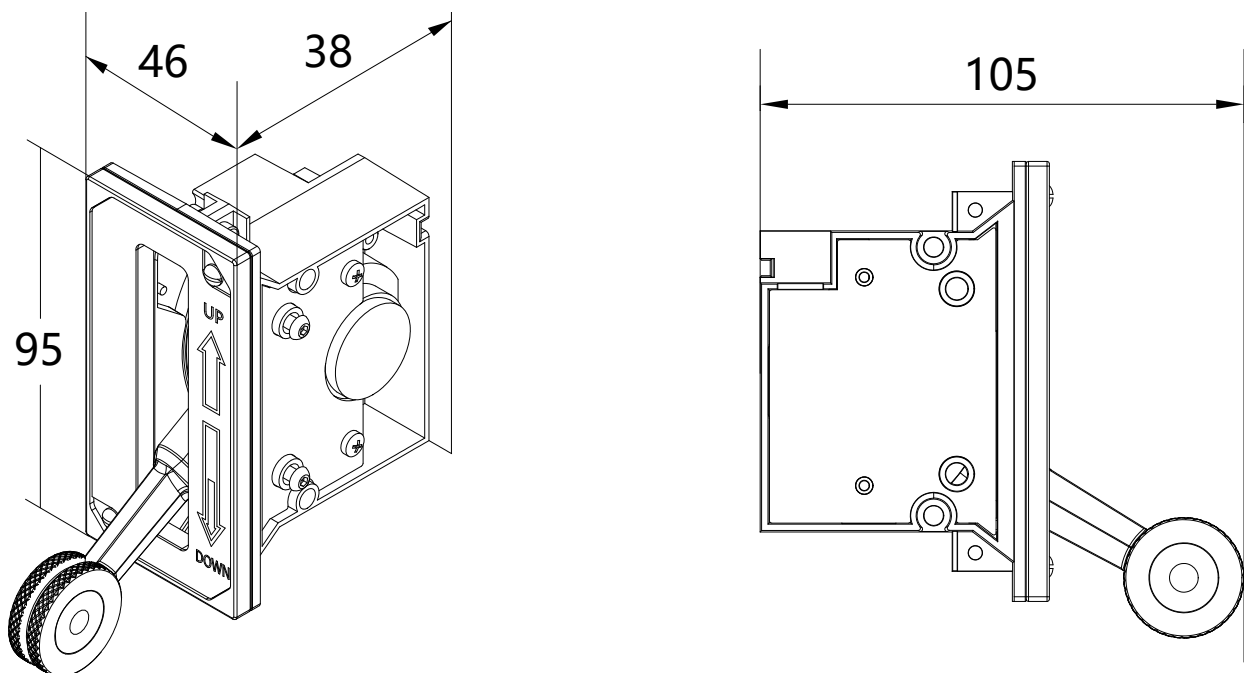

- Bracket dimension (the holes only support M5 screws)

视图A

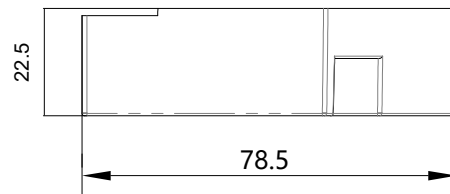
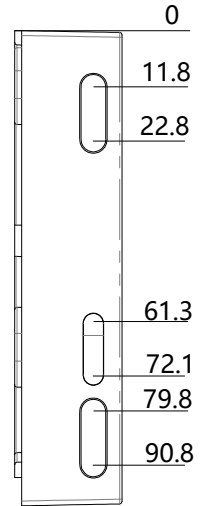
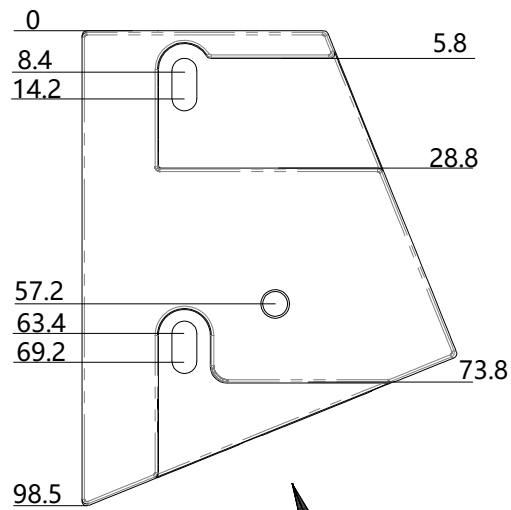
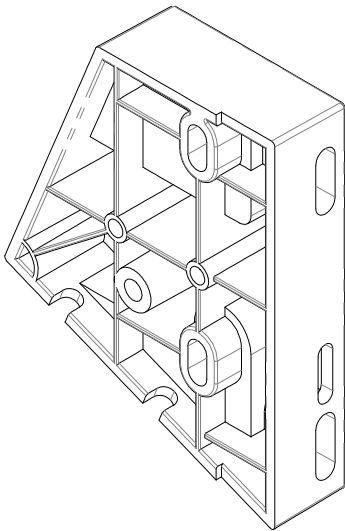
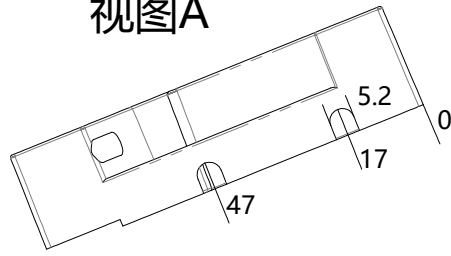

1.4 Installation Dimensions

- Profile installation dimensions

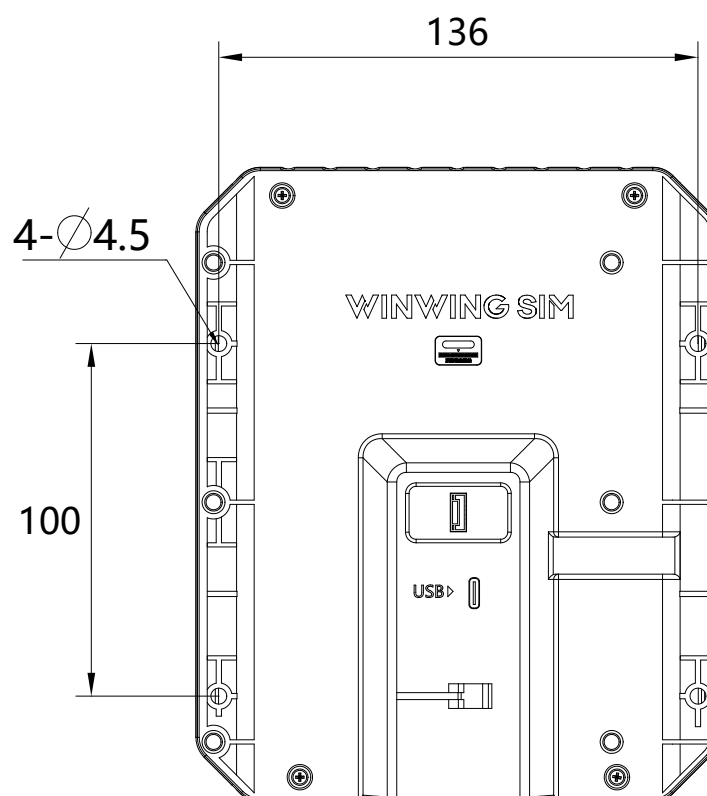

- Bracket installation dimensions

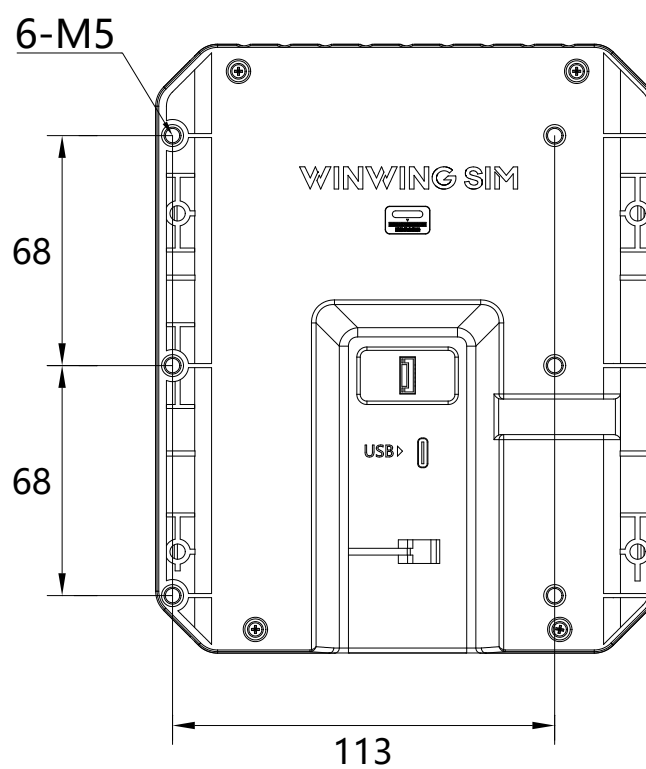

- Landing gear module installation dimensions

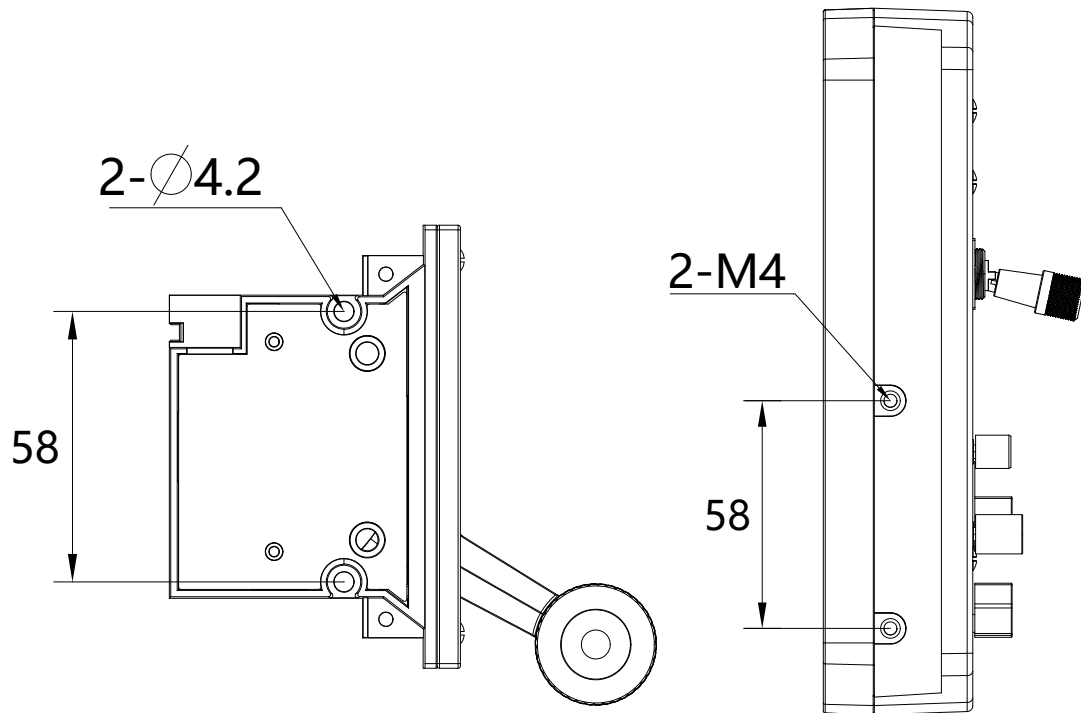

- 32.AGP.Met.1.0 bracket installation diagram and 4080 profile installation diagram (profile and related accessories are needs to be self-prepared, please refer to section 4.2 in this manual for details).

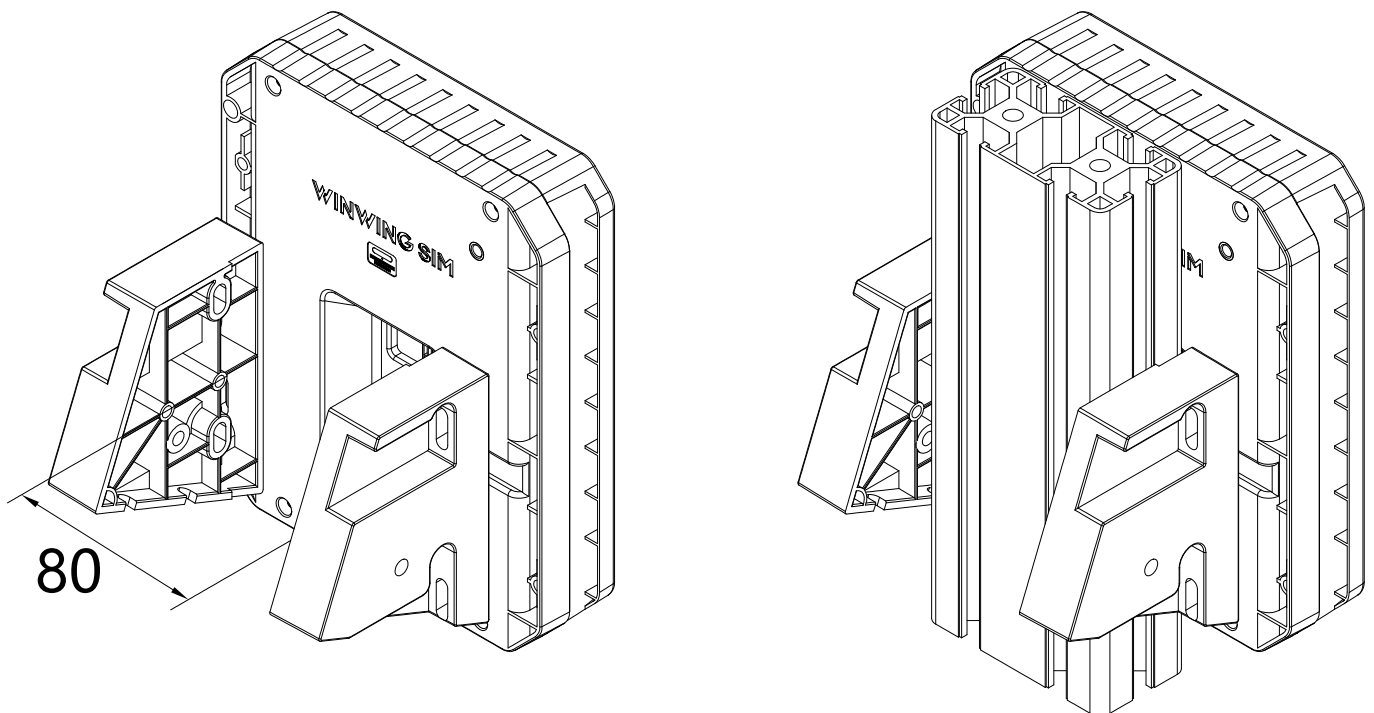

1.5 Installation Compatibility

- Can be used independently.
- Can be installed together with various Winctrl control panels (see upcoming products for details). But does not supports cascading.

Can be used together with Winctrl Panel Mount 1 (NOTE: Only compatible with the new FCU brackets, listed as items 3# and 4# in this manual' s Packing List, which have different mounting holes at the bracket feet. The transition between the new and old brackets version will be subject to the actual received product).

- Can be installed on 4080 profile (profile and related accessories needs to be self-prepared).
- Can be installed on Winctrl Throttle Desk Mount5 (the Throttle Desk Mount5 is sold separately).

2 First Use

2.1 Software Installation

- Download SimAppPro

Download URL:

For Mainland China Download

<https://cn.winctrl.com/view/simapppro.html>

For Global Download

<https://winctrl.com/view/simapppro.html>

- Install SimAppPro

Please follow the instructions to install the software, then run the program.

The product can be customized within SimAppPro. (For more details, refer to the SimAppPro User Manual.)

- When using the product, please run SimAppPro first before entering the game (the product will automatically adapt to supported games and aircraft modules, plug-and-play. For more details, refer to the SimAppPro User Manual).

SimAppPro User Manual Download Link:

Chinese User Manual

<https://cn.winctrl.com/view/regular.html#manual-130>

English User Manual

<https://winctrl.com/view/regular.html#manual-132>

2.2 Parts Installation

- Landing gear installation method 1:
- Screw in the Landing Gear Module from the side.

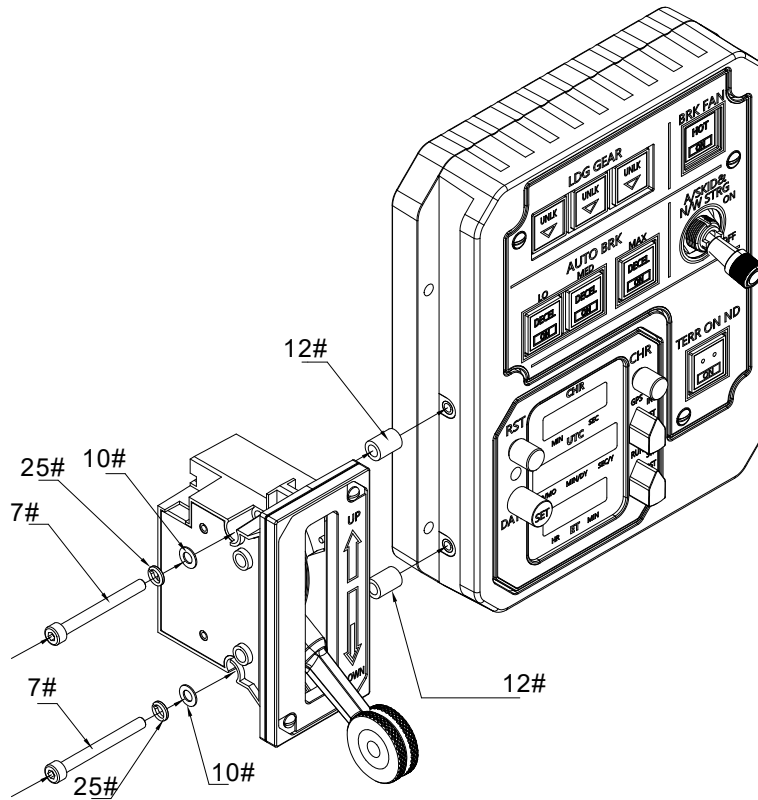

- Install landing gear connection cable.

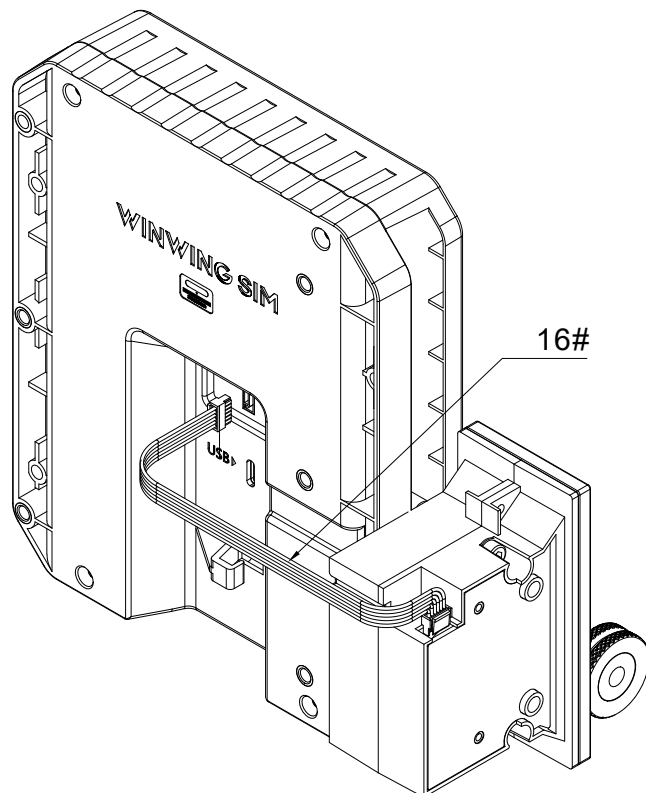

- Landing gear installation method2:
- Install Landing Gear Module with the panel plate.

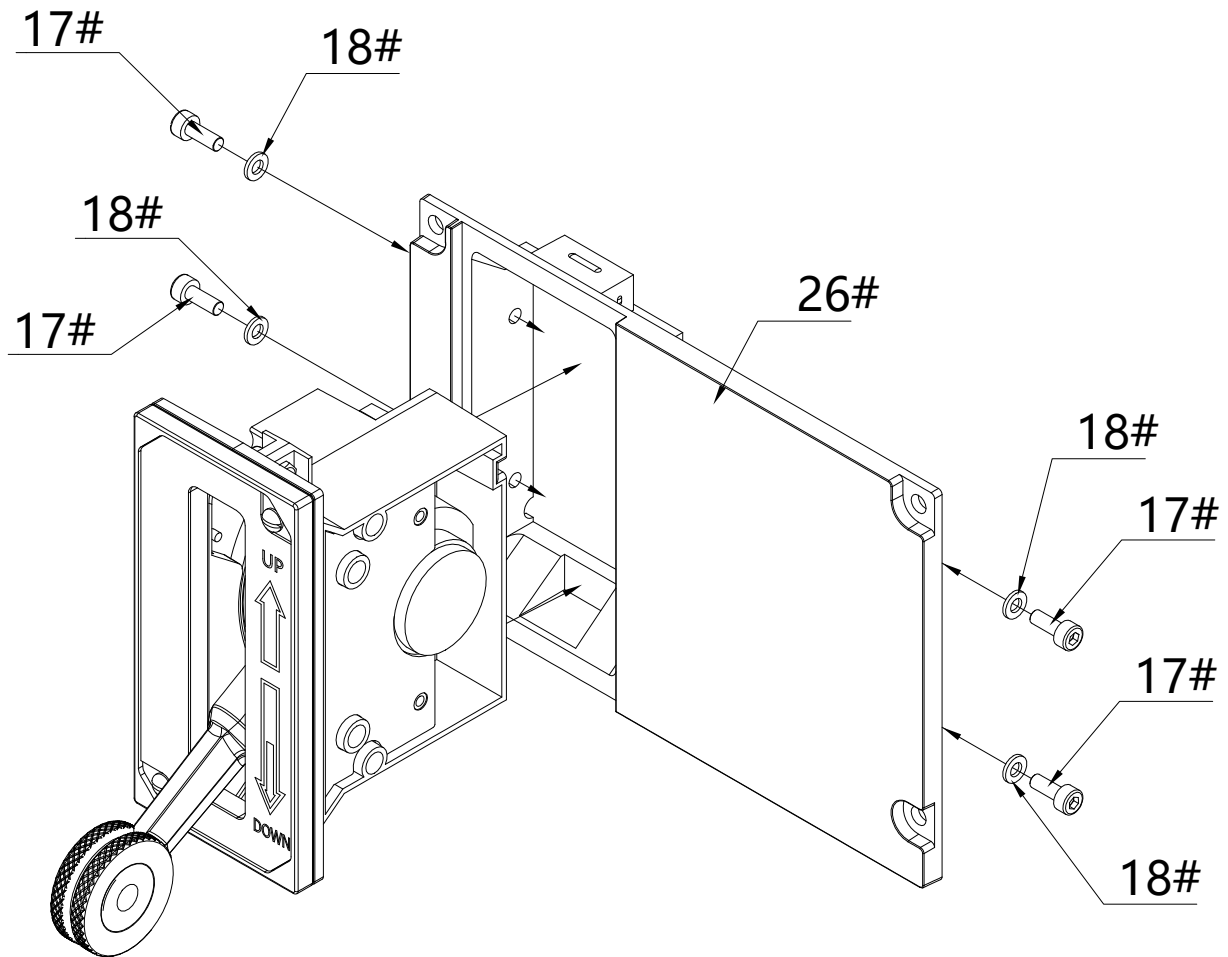

- Install the Landing Gear panel to the assembly.

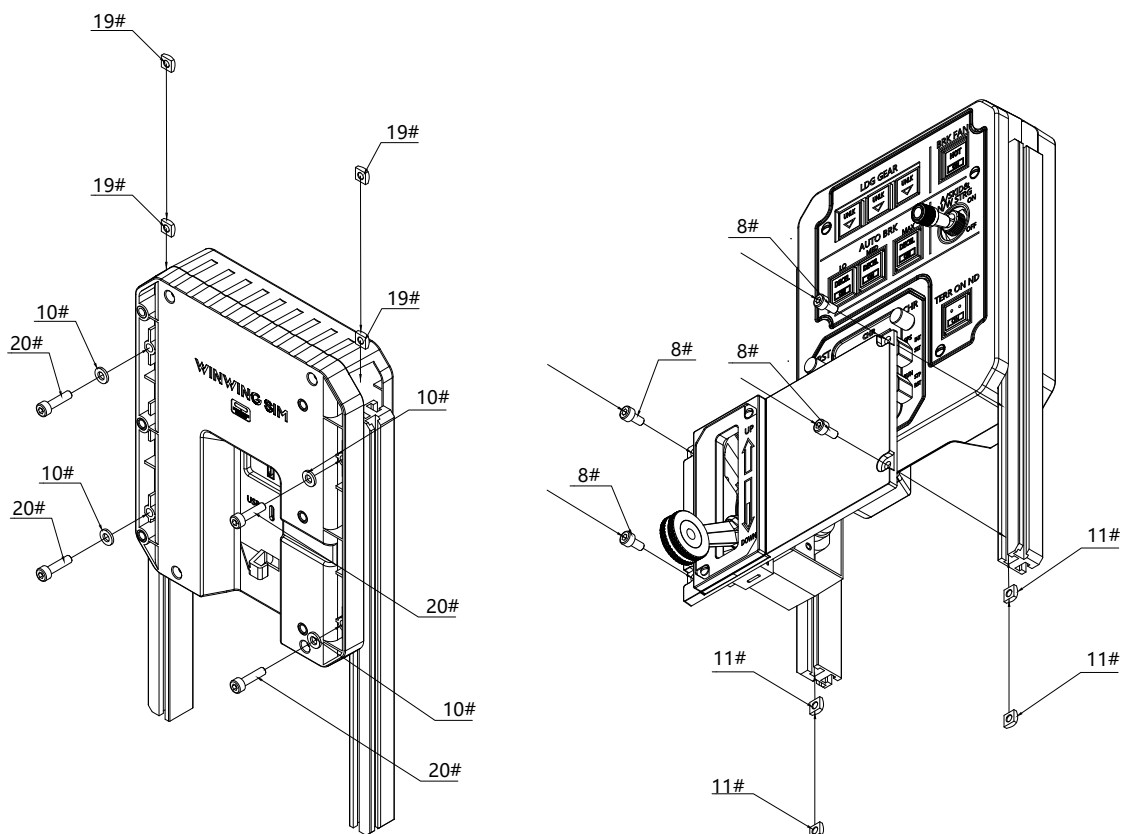

- Complete cable connection.

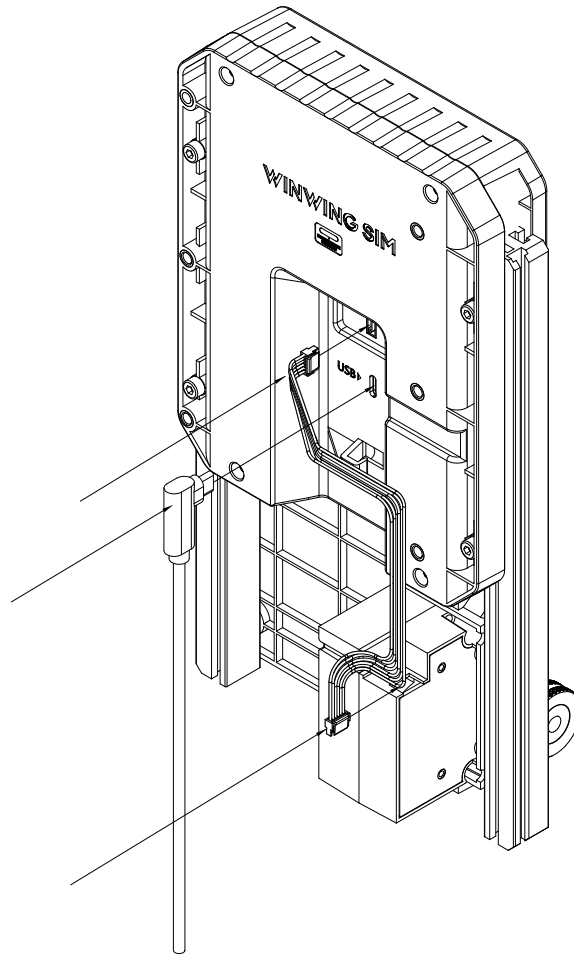

2.3 How to Use

- Device Connection

The product connects to the computer via the included data cable. For details on the interfaces, refer to Section 3.3 Data Interface.

How to Connect

Insert the included landing gear connection cable (16#) . (See 2.2 Parts Installation for details)

Then insert the included data cable (15#) into the product's USB data interface and connect it to your computer.

For products requiring assembly, only the USB interface supports hot-swapping. For

other interfaces, ensure that the product is properly connected before connecting to the computer.

(Important: If you need to connect other interfaces such as PS2, SATA, or aviation connectors, make sure to disconnect the USB cable before proceeding.)

After connecting the product to the computer, secure the cable with R Shape Cable Clip to the bracket (see Section 4 Installation Methods for details), so as to prevent damage to the product' s interface.

3 Function

3.1 Mechanical and Special Features

- Blank

3.2 Buttons

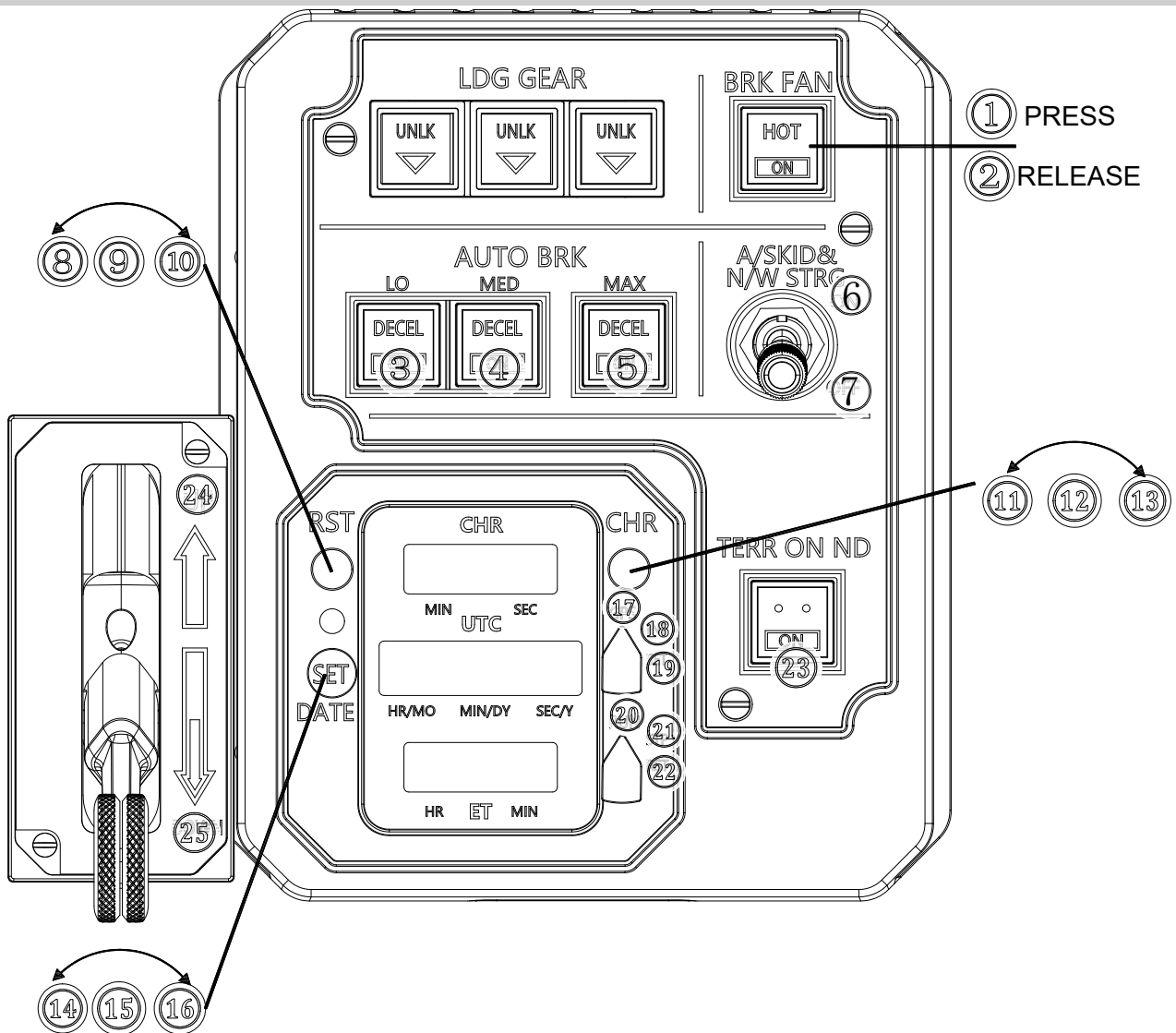

- LED Status Indicator:

- Green steady slow flash (1s interval) — BOOT Mode
- Green slow flash (1s interval) for 5 times, then steady on — Operation Mode
- Green slow flash (1s interval) for 5 times, then off — Power-Only Mode

3.3 Data Interface

- USB Data Port

Used for communication and power supply between the product and the computer.

Simply connect this cable to use the product.

Communication Protocol: HID

- Landing Gear Port

Used for communication and power supply between the 32.AGP.Met.1.0 and landing gear module. Simply connect the module to use the product.

3.4 Adjustment Method

- Landing gear module damp adjustment.
- Pull the landing gear handle to UP position;

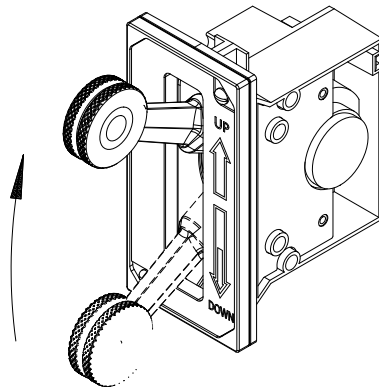

- Use the included tool T2 to rotate the screw as shown in picture, rotate clockwise to increase the damp, counterclockwise to decrease the damp. *NOTE: Please do not over-tighten the screw with excessive force, over-tightening may result in product damage.

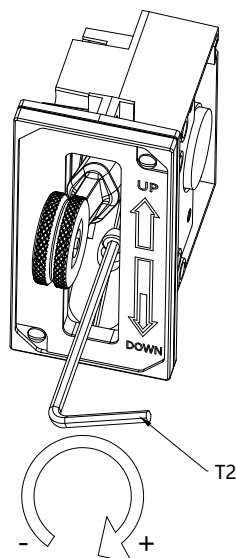

- Panel positioning angle can be adjusted when used with Winctrl Panel Mount 1 (see MP1 User Manual for details).

(NOTE: Only compatible with the new FCU brackets, listed as items 3# and 4# in this manual's Packing List, which have different mounting holes at the bracket feet. The transition between the new and old brackets version will be subject to the actual received product).

4 Installation Methods

4.1 Desktop Mounting Method

4.1.1 Desktop Mounting Method 1 (recommended for desktop use)

- Mounting method:
- Install landing gear module to the side.

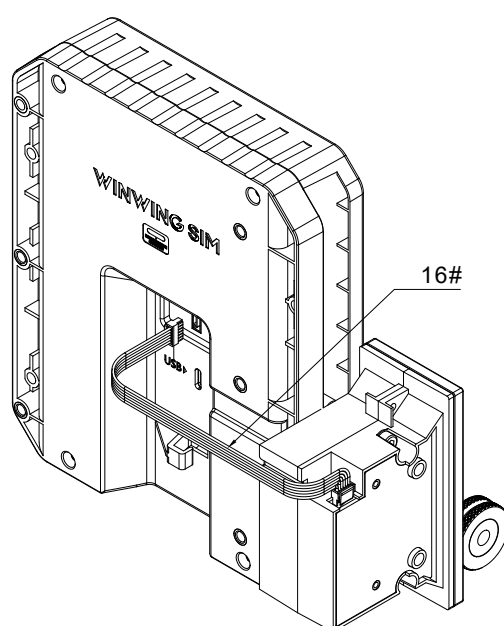

- Screw in the left and right bracket.

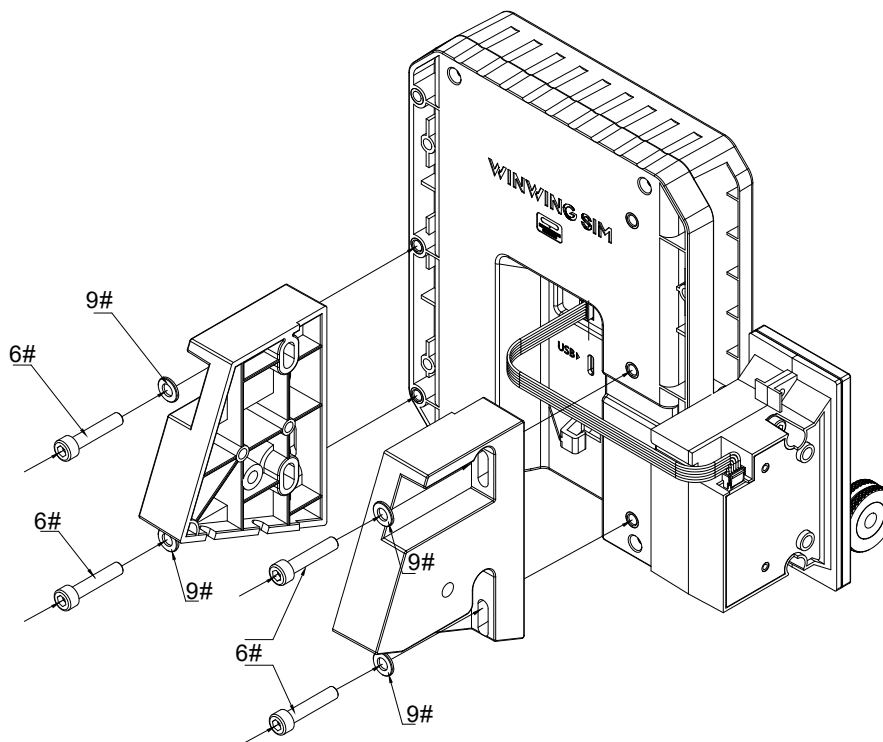

- Slide the square nut into the profile, screw in, but do not tighten them yet.

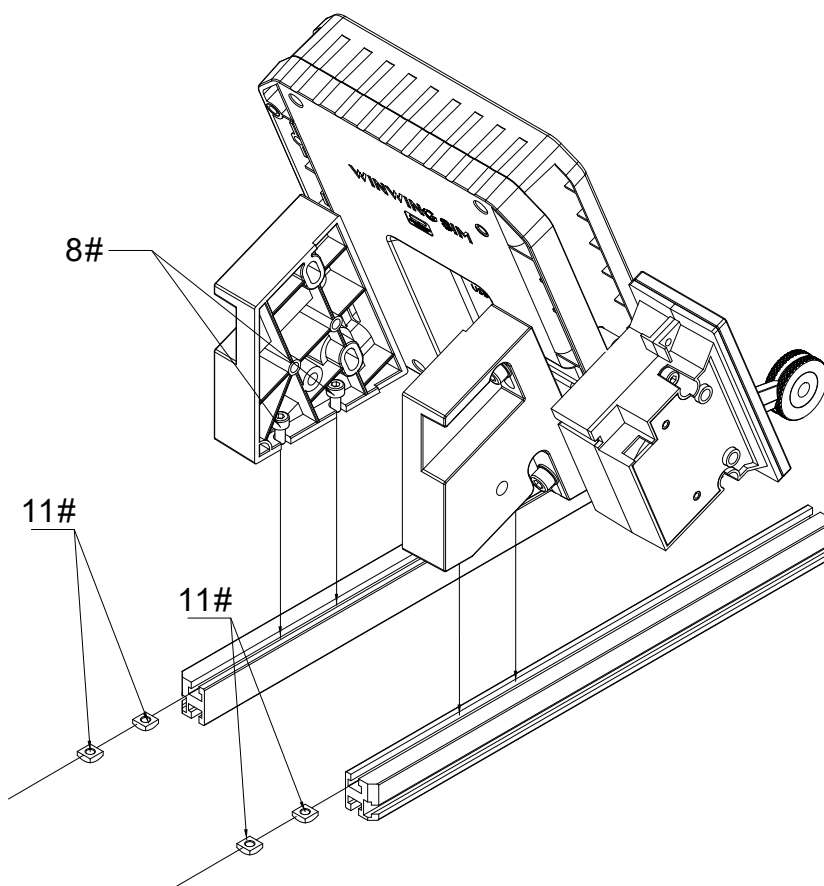

- Apply the Nano Double Sided Adhesive Dots. (14#)

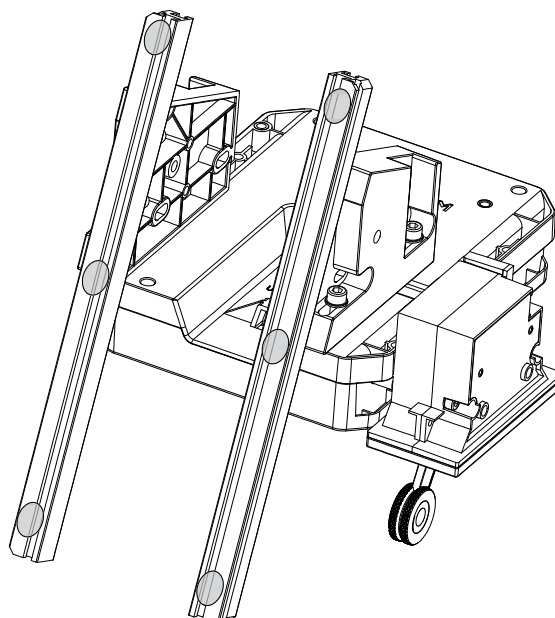

- Adjust the bracket position up and down until it is stable on the desktop, then tighten the screws;
- Tighten the screws until there is no wobbling; over-tightening may cause damage.

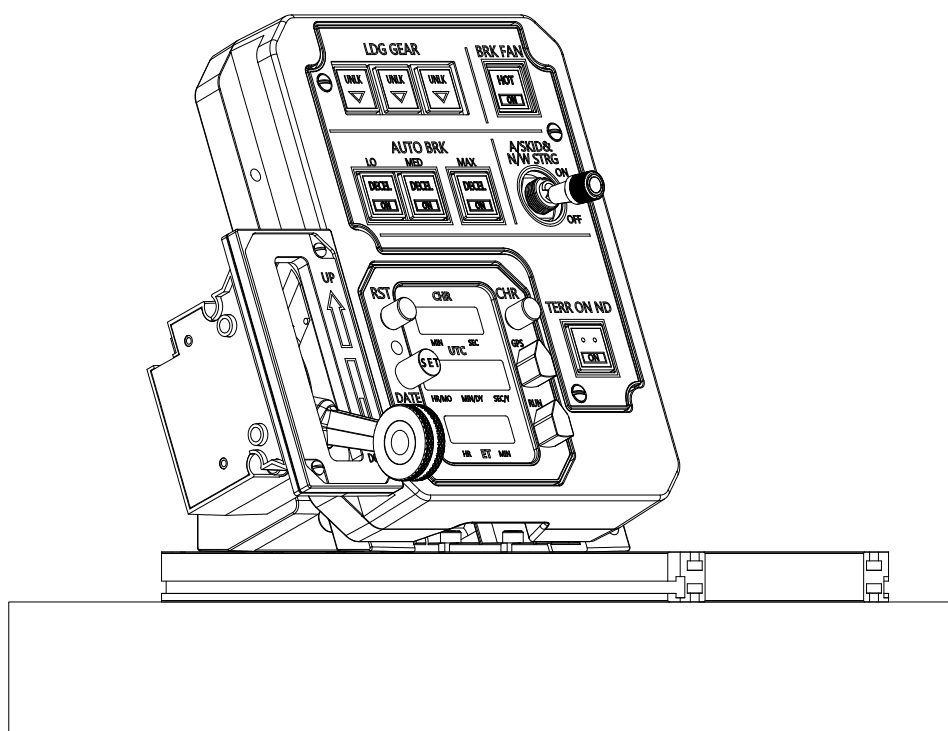

- Clean the dust off the bracket surface before applying the adhesive dots.
- Press firmly for at least 10 seconds during application and let it sit for 30 minutes to ensure the best adhesive effect.
- For single-use application only on clean, smooth surfaces. Do not apply to surfaces with wax, oil, water stains, dust, dirt, or rough textures to avoid improper adhesion and potential detachment.
- The ideal temperature for application is between -10° C and 40° C.

4.1.2 Desktop Mounting Method2

- Mounting method:
- Install the landing gear module to the side.

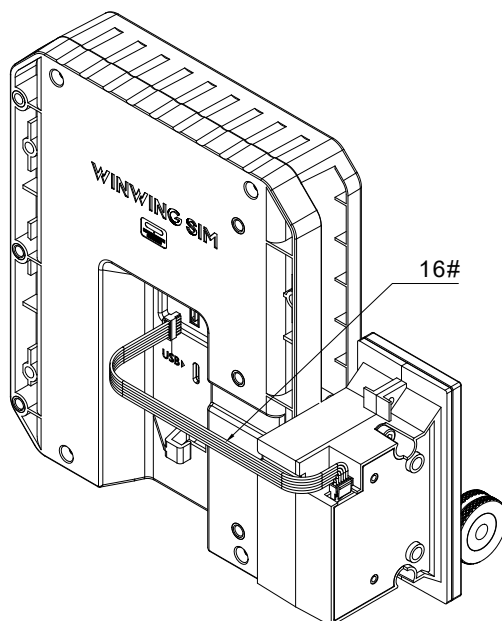

- Screw in the brackets, but do not tighten them yet.

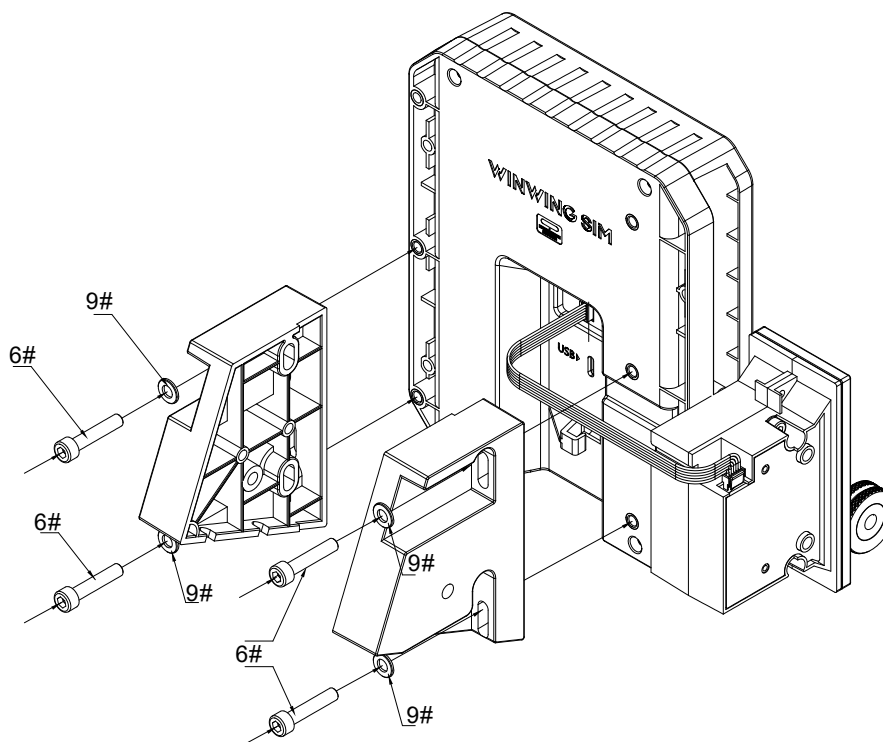

- Apply the Nano Double Sided Adhesive Dots (14#) to the bottom of the bracket.

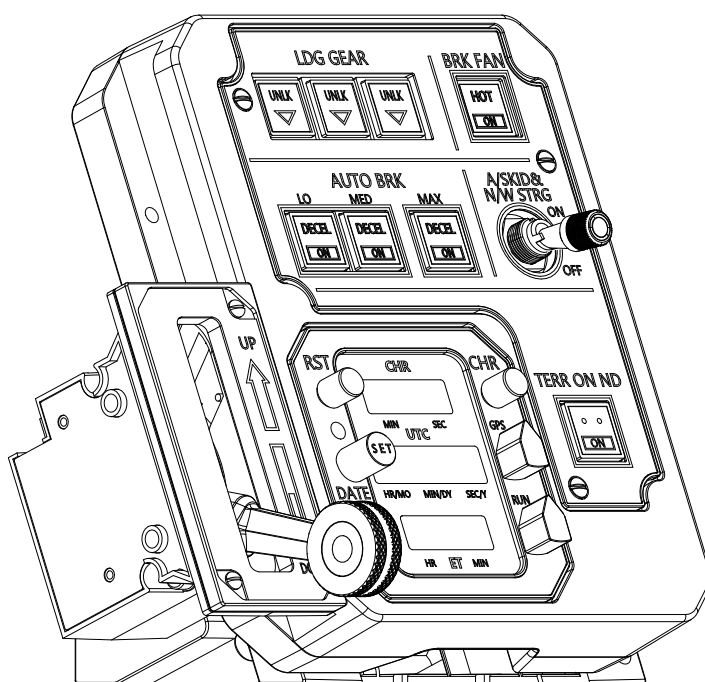
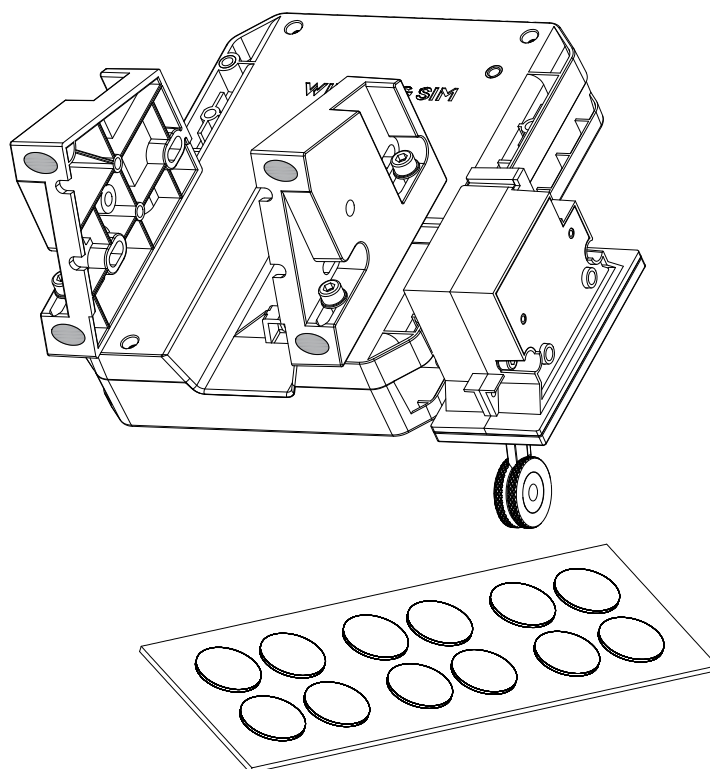

- Adjust the bracket position up and down until it is stable on the desktop, then tighten the screws;
- Tighten the screws until there is no wobbling; over-tightening may cause damage;

4.2 Profile Installation (*Profile bars and related accessories need to be

self-prepared.)

4.2.1 4080 profile installation

- Recommended Specifications for Self-Prepared Accessories

Item	Specifications	Quantity (Minimum)
Profile Bar	EU Standard 4080	1
Profile Nut	40 Series-M5	4
Hexagon Socket Cap Screw	M5*22	4
Flat Washer	M5	4

- Install USB data cable first.

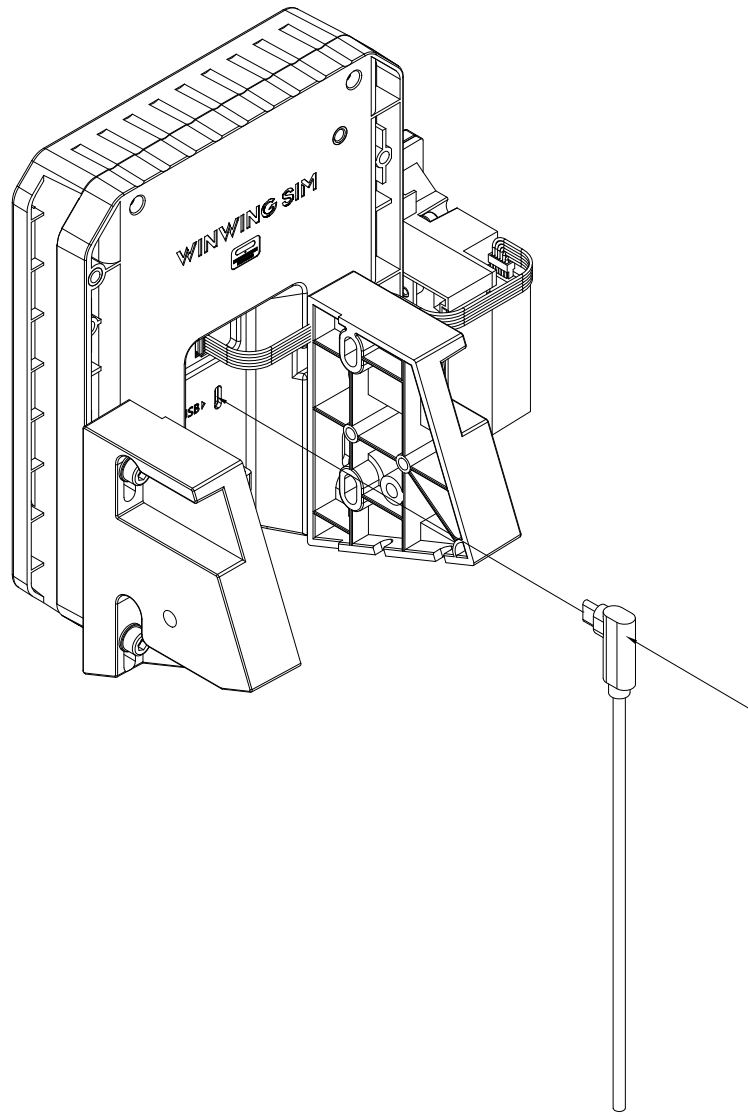

- Slide in the profile nuts, adjust 32.AGP.Met.1.0 position, then tighten the screws.

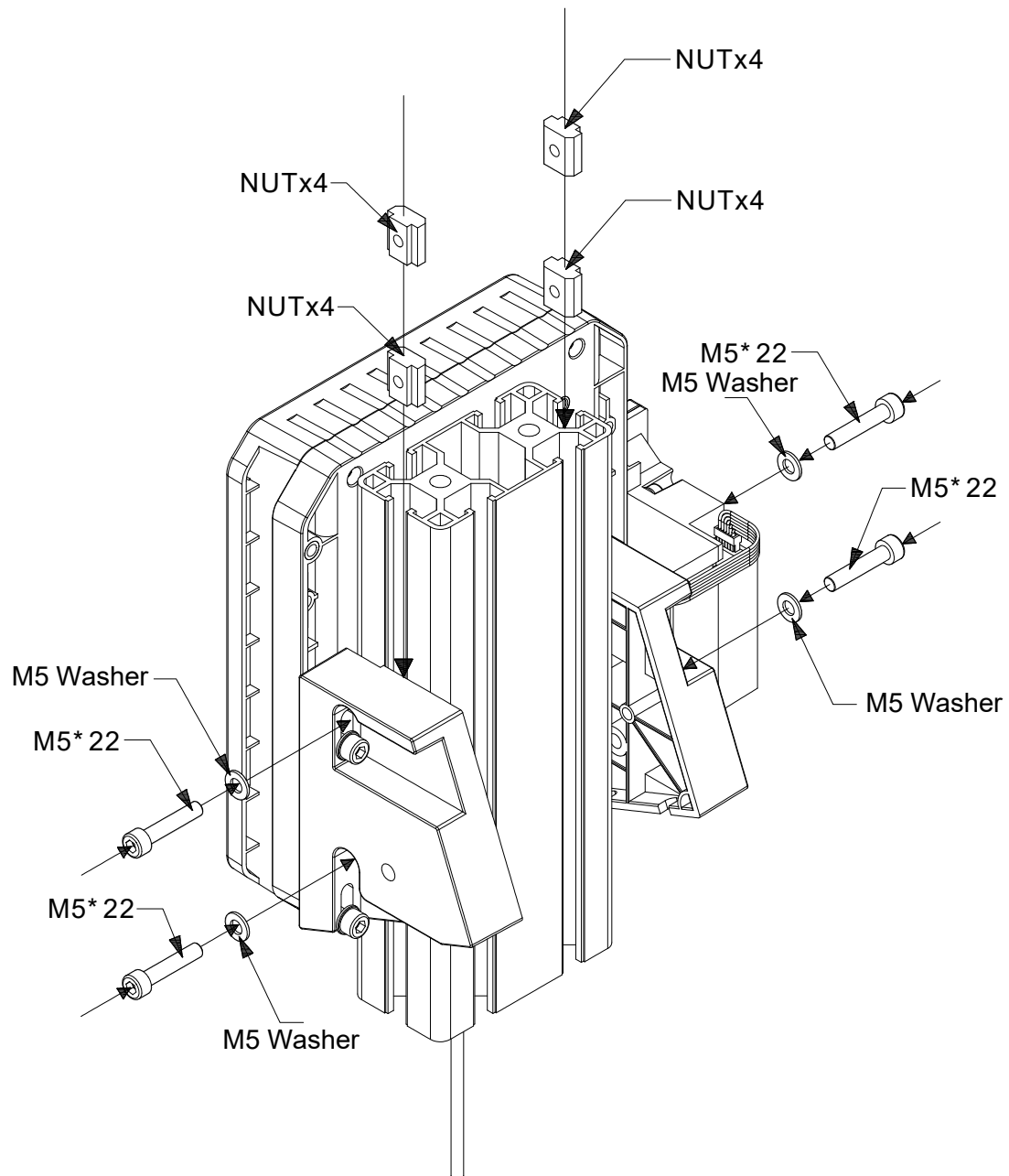

4.2.2 2060 profile installation

- For 2060 profile installation, please refer to Section 4.3 of Winctrl Throttle Desk Mount5 Mounting Method

4.3 Winctrl Throttle Desk Mount5 Mounting Method(Winctrl

Throttle Desk Mount5 is sold separately)

- This section will take the Landing gear installation method 2 as example, for Landing gear installation method 1 it' s same as below, and it will not be informed repeatedly here.
- For Winctrl Throttle Desk Mount5 install method please refer to MT.N.N.5.1 User Manual, and it will not be informed repeatedly here.
- Complete Landing gear installation method 2 and connect the cables.

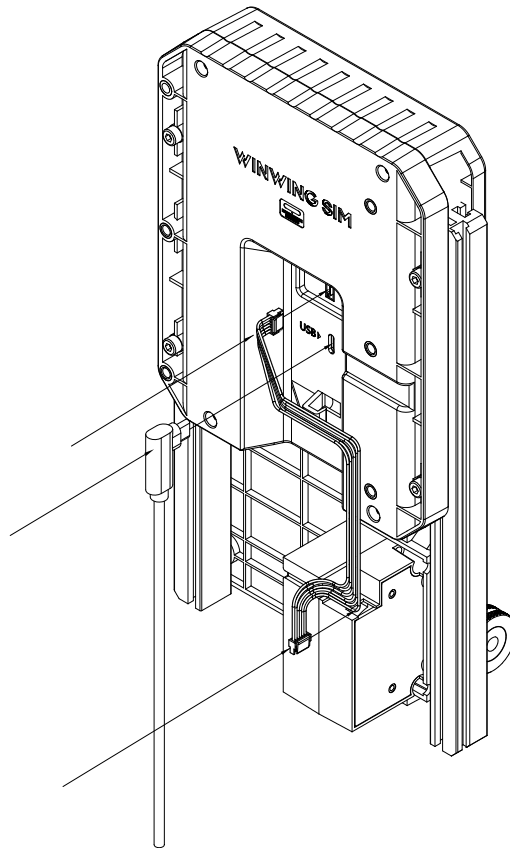

- Screw in the left and right bracket.

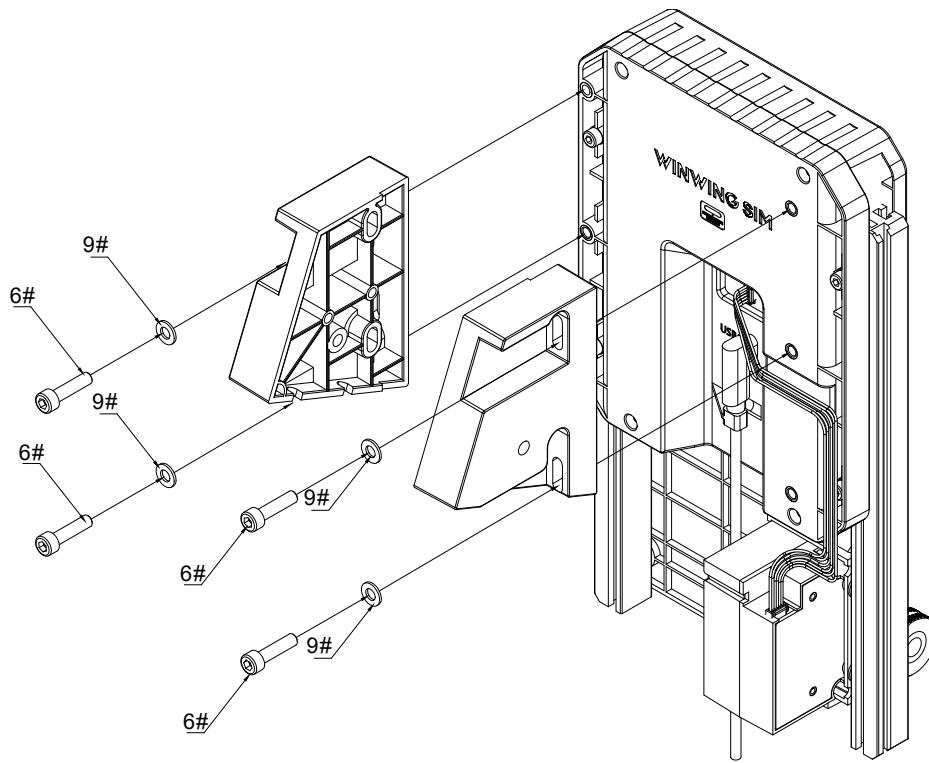

- Slide the nuts into the bracket.

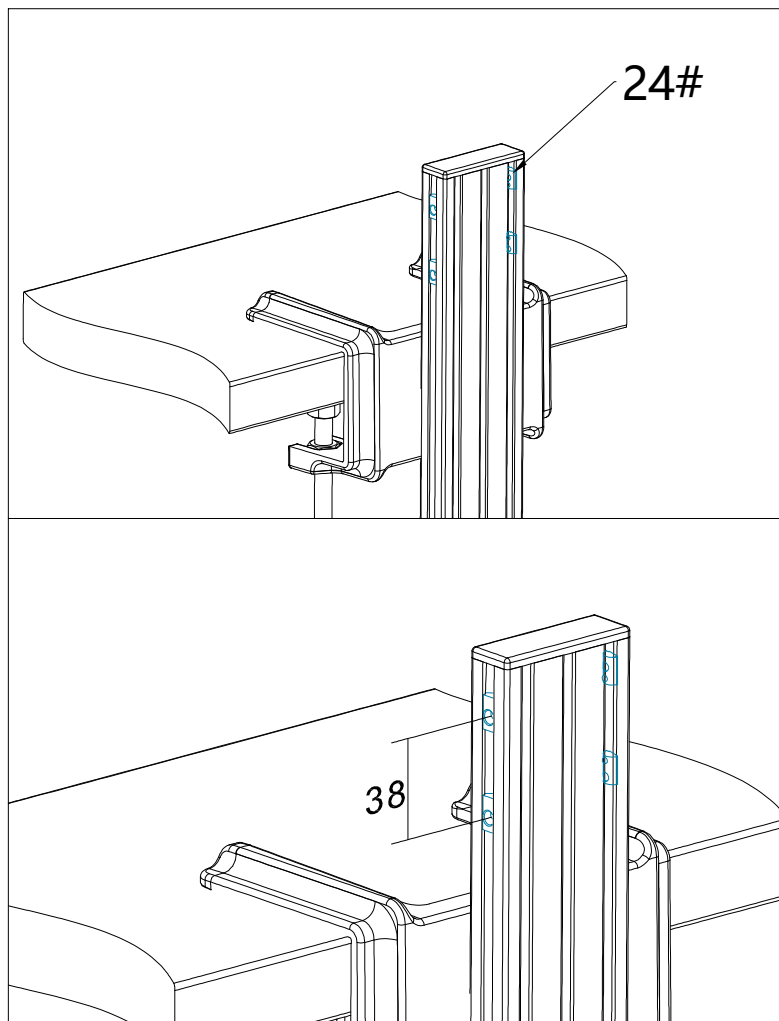

- Mount the 32.AGP.Met.1.0 on Winctrl Throttle Desk Mount5.

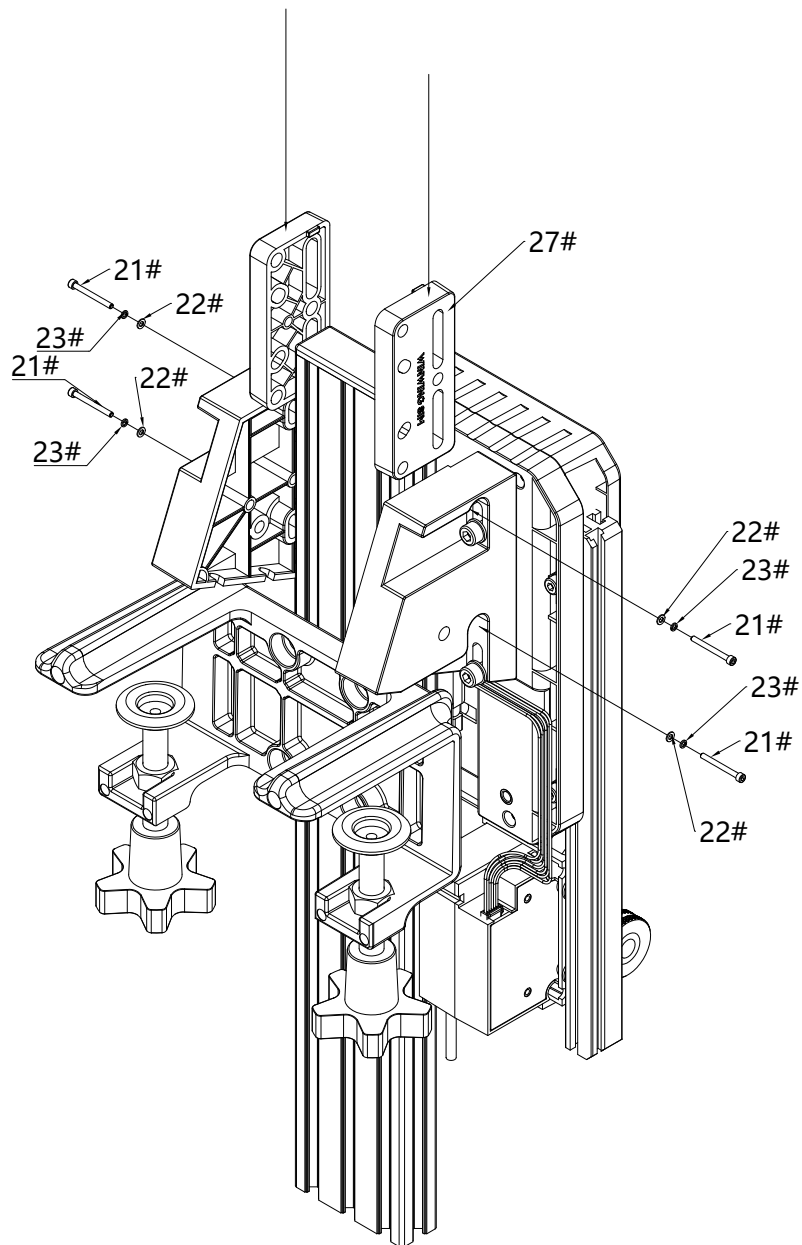

4.4 Integrated Device Installation

- Can be installed together with different control panels, see upcoming products for details.
- Can be installed together with panel 32.ECAM.1.0.*Panel 32.ECAM.1.0 is sold separately.
- Mounting method 1 (recommended for desktop use):
- Install landing gear module to the side.

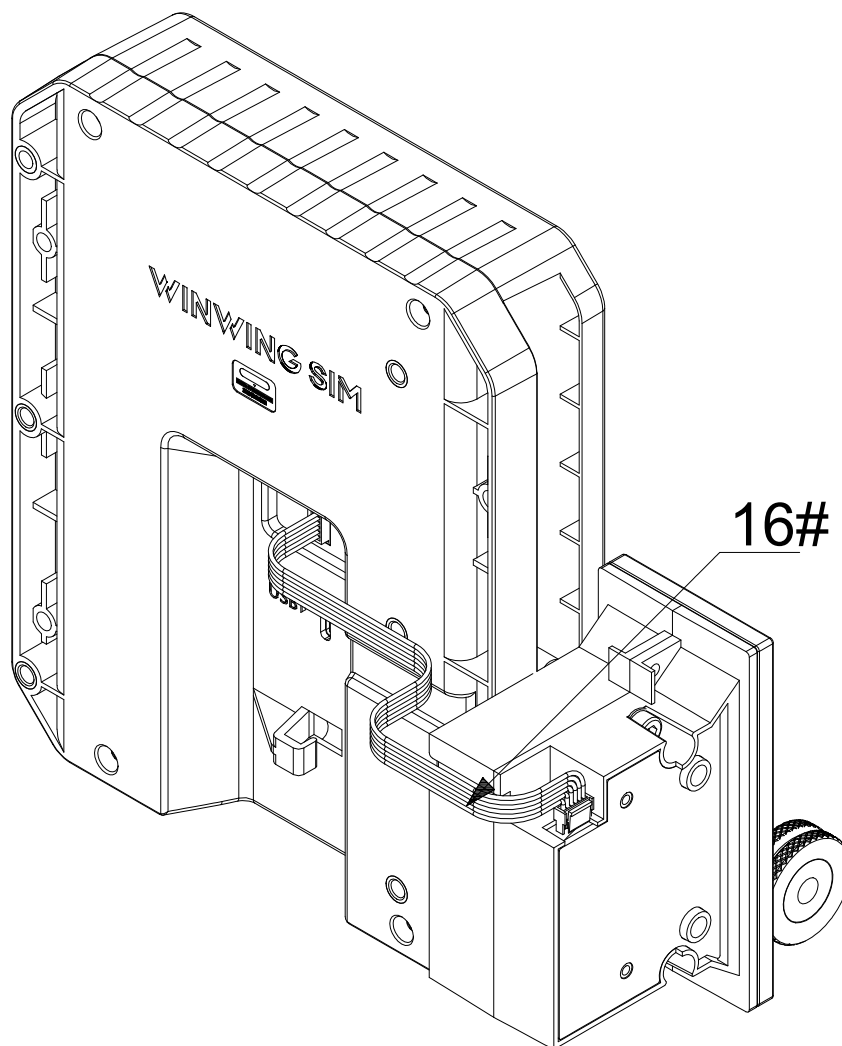

- Screw in the left and right bracket.

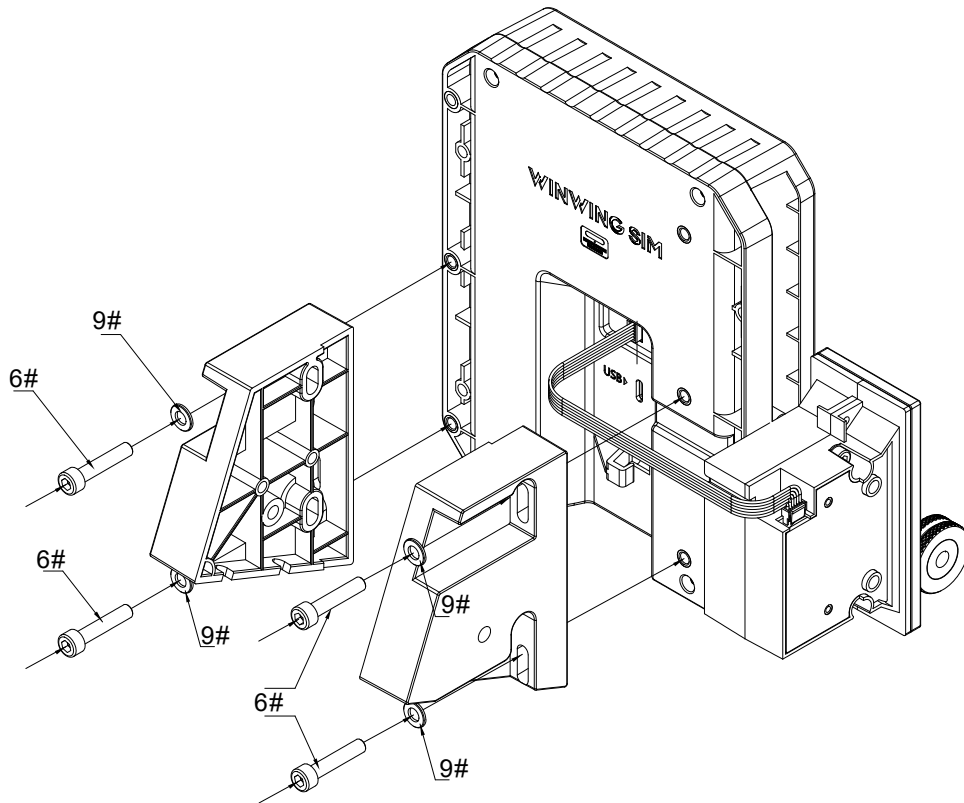

- Slide the square nut into the profile, screw in but do not tighten them yet.

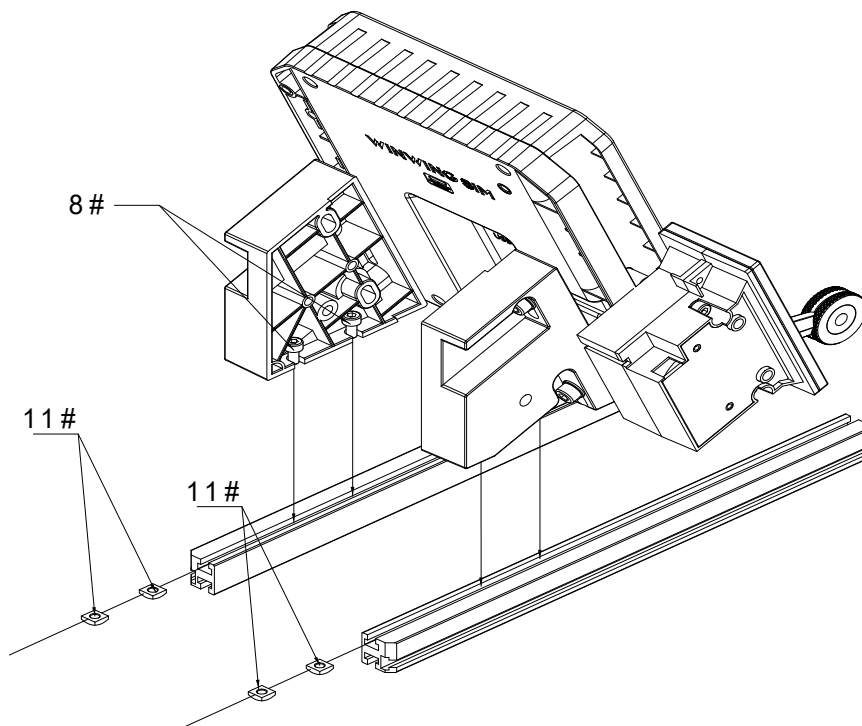

- To install 32.ECAM.1.0, apply the Nano Double Sided Adhesive Dots. Clean the dust off the bracket surface before attaching.

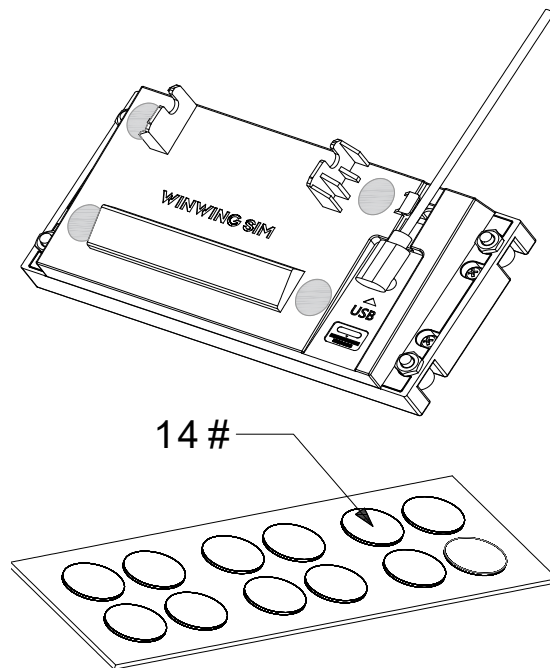

- Attach 32.ECAM.1.0 to the 32.AGP.Met.1.0 guide rail as the picture shown below;
- Apply adhesive dots (14#) to the bottom of the guide rail;
- After cleaning the dust off the desktop, attach 32.AGP.Met.1.0 and 32.ECAM.1.0 to desktop surface.

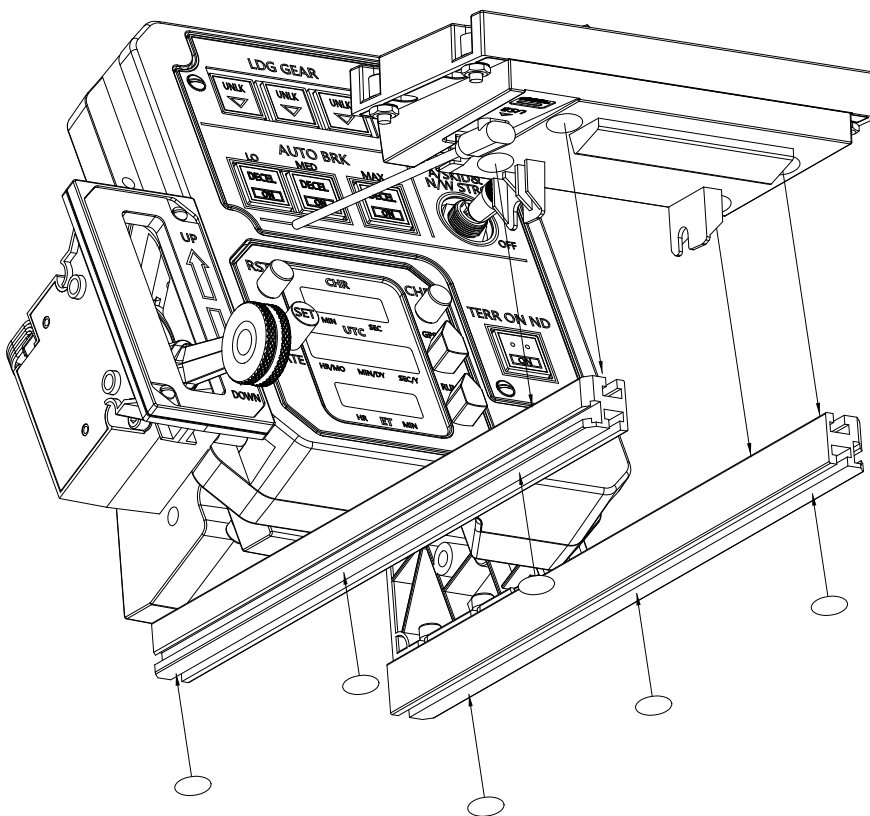

5 Maintenance and Care

5.1 Firmware Upgrade

- Firmware Upgrade via SimAppPro

Before upgrading, ensure the product's wiring is securely connected and follow the instructions on the SimAppPro interface.

If you encounter issues during the upgrade, try restarting SimAppPro and reconnecting the device's USB Data Port.

* NOTE: Other interfaces, such as PS2 or SATA, do not support hot-swapping. If you need to connect these interfaces, please disconnect the USB cable first.

If the upgrade still cannot be completed, please contact Customer Service on Winctrl website for technical support.

5.2 Cleaning and Maintenance

- To prevent accidental dust and dirt entering its interior, the product features a dust-proof design. However, it cannot guarantee complete prevention from dirt, dust, water or salt. Please keep the product clean and avoid above debris as much as possible.
- It is recommended to clean the product after use. Allowing dirt, dust, water or salt to remain on the product may cause malfunction.
- Do not place the product near objects with strong magnetic fields, such as magnets or electric motors. Strong magnetic fields may cause abnormal data from the product.

- Do not place the product in high-temperature areas, such as being exposed to direct sunlight inside a car. High temperatures may cause product malfunction.
- The product contains precision electronic circuits. Do not disassemble the product by yourself.
- Do not touch the product's electronic contacts with your fingers to avoid corrosion. Corroded contacts may lead to product malfunction.
- If the product is suddenly moved from a low-temperature environment to a warm room, condensation may form on the surface and interior. To prevent condensation, place the product in a sealed plastic bag and wait for the temperature to gradually rise before removing it from the bag.
- If condensation occurs on the product, refrain from using it to avoid damage. Wait for all moisture to evaporate before continuing to use the product. Even the product is fully dried, the internal components may still be at a low temperature.
- Avoid storing the product in chemical laboratories or areas with chemicals that may cause rust or corrosion.
- Use only original parts for maintenance and replacement.

5.3 FAQs and After-Sales Service

Frequently Asked Questions:

- If the product is experiencing abnormalities, please check if the firmware and SimAppPro version are up to date and perform an upgrade if necessary.
- If you experience signal instability or drift during use, try re-calibrating within SimAppPro or clearing the game controller data in Windows.

- If the product is having issues with unstable connection or is not recognized by the computer, try switching to a different USB port (it is recommended to use a USB port directly on the motherboard or a three-prong USB hub with independent power and proper grounding). Also, try cleaning the data cable's connectors with alcohol or replacing the cable to see if the signal stabilizes.

* NOTE: If you need to connect other interfaces, such as PS2 or SATA, please disconnect the USB cable first before proceeding.

- After connecting the product to the computer, make sure to secure the cables in the fixed clips to prevent damage to the product's connectors.
- When assembling and connecting the product and accessories, ensure that the screws are tightened correctly and that no components are loose or over-tightened. Incorrect handling may cause unusual sounds during operation.
- When using a USB hub to connect the product, ensure that the three-prong hub has independent power supply and proper grounding. Otherwise, the product's signal may be unstable.

6 Safety Precautions

For safe use of the product, please be sure to read and follow these precautions to prevent harm or injury.

- Keep the product out of the reach of children.
- Swallowing product parts or accessories is extremely dangerous. If swallowed accidentally, seek medical attention immediately.
- The moving structural parts of the product are lubricated with grease or damping

compounds. Please do not touch them, as accidental ingestion may be harmful to health.

- Use only the intended power supply specified in the product user manual.
- Do not disassemble or modify the product.
- Do not subject the product to strong impacts or vibrations.
- Do not touch any exposed internal components.
- If the product emits smoke, unusual odor, or exhibits any abnormal behavior, stop using it immediately.
- Do not clean the product surface with organic solvents such as alcohol, gasoline, or paint thinner.
- Do not get the product wet, and do not insert foreign objects or pour liquids into the product.
- Do not use the product in environments where flammable gases may be present, as static electricity may cause explosions or fires.
- During thunderstorms, do not touch the product connected to a power outlet, as this may result in electric shock.

Disclaimer

Please read and understand the contents of the product user manual carefully. Failure to follow the instructions may result in personal injury or damage to the product.

Ensure that all personnel using this product are familiar with and understand the user manual for best utility.

Any personal injury, property damage, or product damage resulting from improper use or

failure to follow the user manual will be the sole responsibility of the user. The company will not be held liable for such incidents.

When users are using the product:

Users should install, handle, store, use, maintain, and dispose of the product according to the product guidelines, relevant laws, regulations, and safety standards, without violating any applicable laws.

Since the conditions and methods in which the user uses this product are beyond the control of the company, the company is not liable for any consequences arising from the following situations. The responsibility lies solely with the user:

- Personal injury, property damage, or product damage caused by improper user operation, failure to follow the product user manual, or other uncertain factors.
- Changes in the product's technical specifications, data, or content of the user manual due to improvements in reliability, functionality, design, or other reasons, without prior notice.

NO: 20241018-01A-P

WINCTRL