

# URSA MINOR-Airlines-Joystick R

User Manual V1.0 2024.06

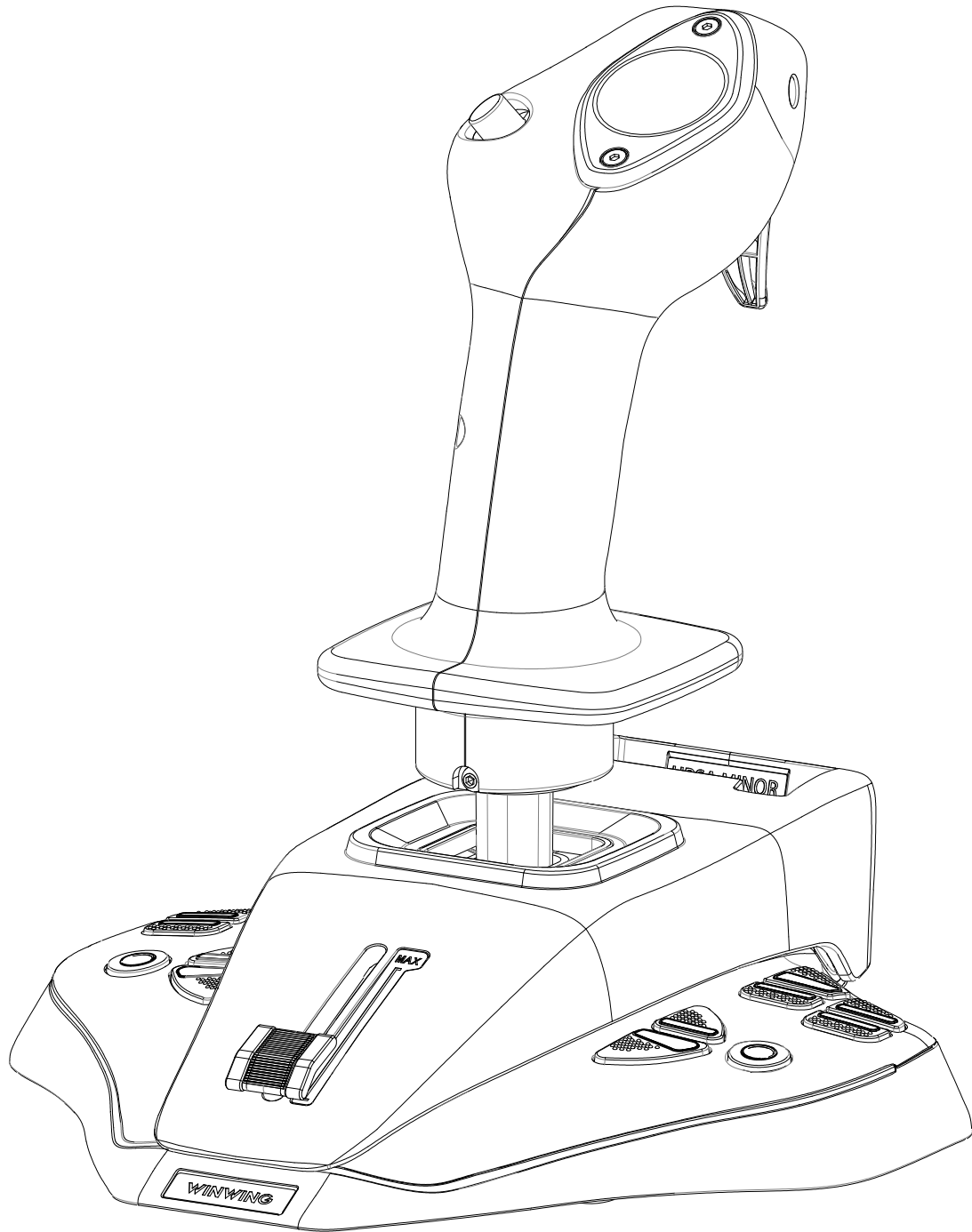

# Catalog

Packing List .....	1
1 Parameters.....	2
1.1 Performance Parameter .....	2
1.2 Applicable Models .....	4
1.3 Dimensions .....	5
1.4 Installation Dimensions .....	6
2 Functions.....	7
2.1 Buttons and Functions .....	7
2.2 Adjustment Methods .....	10
3 Components Assembly and Disassembly.....	12
4 Installation of Connectors.....	12
5 Installation Methods.....	12
5.1 Desktop Mounting .....	12
5.2 Game Seat Mounting .....	14
5.3 Cascading .....	14
6 Calibration.....	15
6.1 X and Y Axes Joystick Calibration .....	15
6.2 Z Axis calibration .....	16
6.3 Slider Axis Calibration .....	18

# Packing List

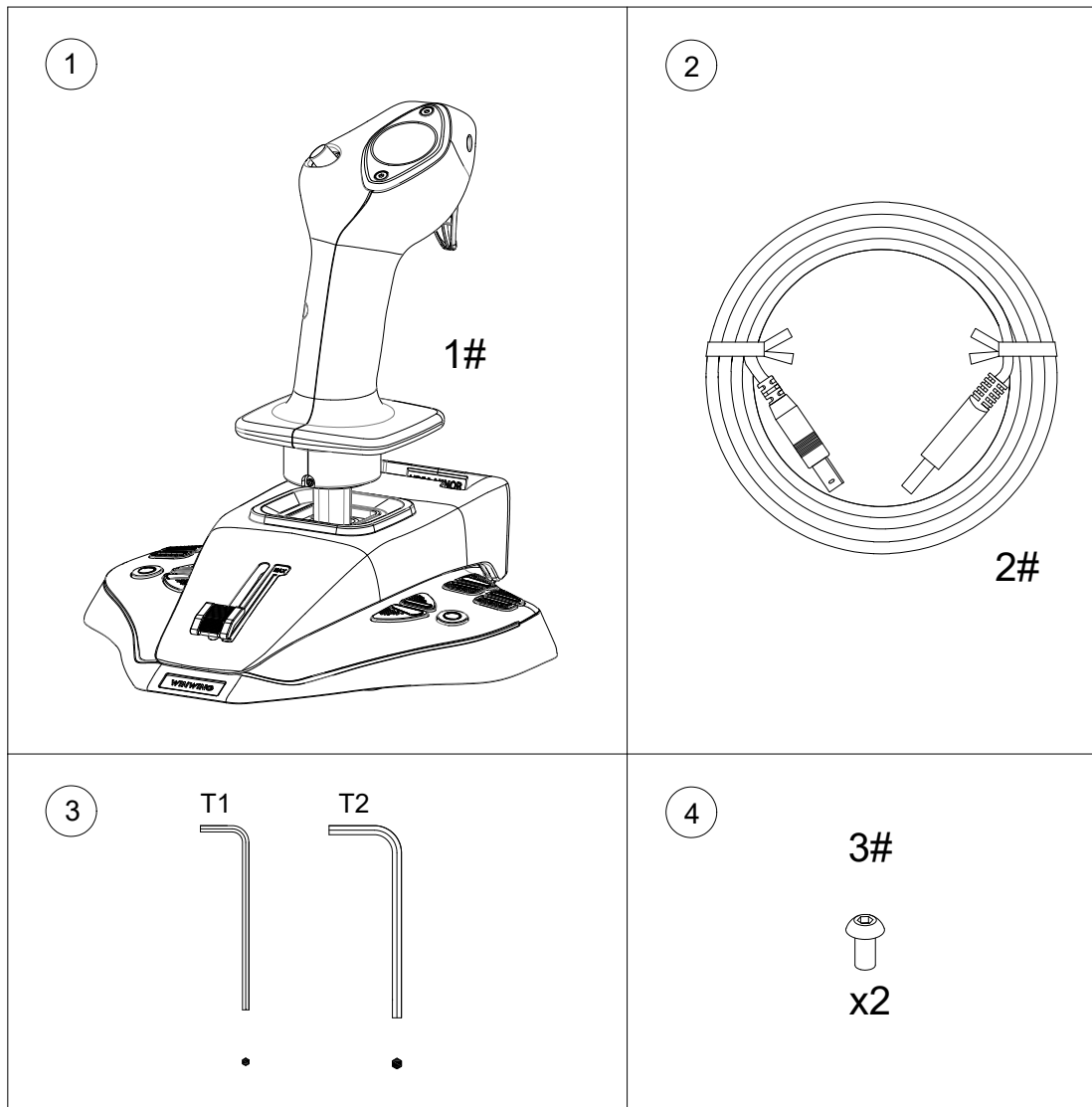

①	J5-BASE-BLUE+JGRIP-C1-R (1#)	1
②	Data Cable (2#)	1
③	Tool Kit	1
	T1: T1:2.0mm Hex Allen	1
	T2: T2:2.5mm Hex Allen	1
④	Accessory Kit	1
	3#) M3*6 Hex Socket Head Cap Screw (3#)	2

# 1 Parameters

## 1.1 Performance Parameter

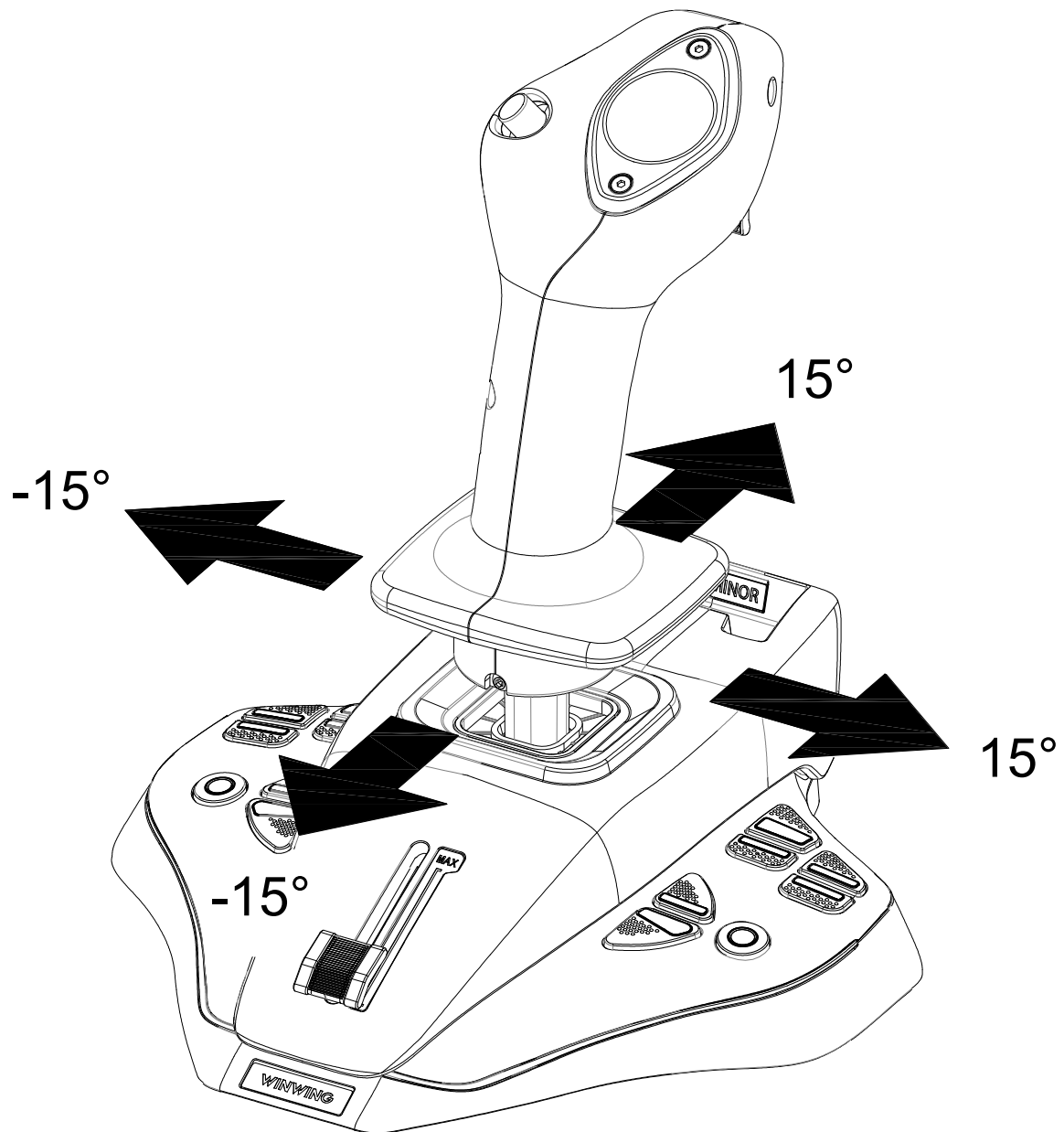

\*X/Y Axis Movement Angle:  $\pm 15^\circ$ , Operating Force:  $\sim 6\text{N}$

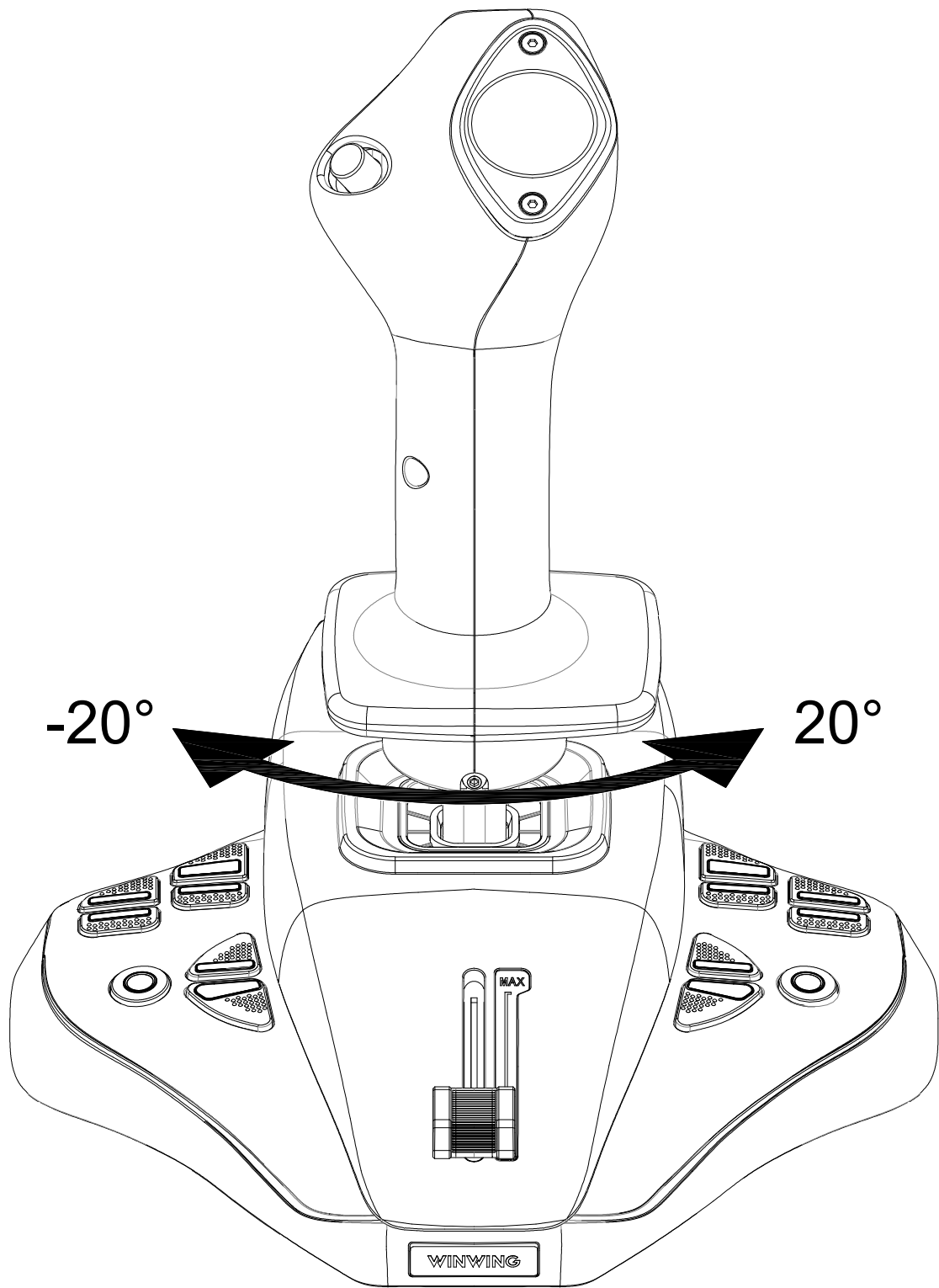

\*Z Axis Rotation Angle:  $\pm 20^\circ$ , Rotation Torque:  $\sim 4\text{kgf}\cdot\text{cm}$

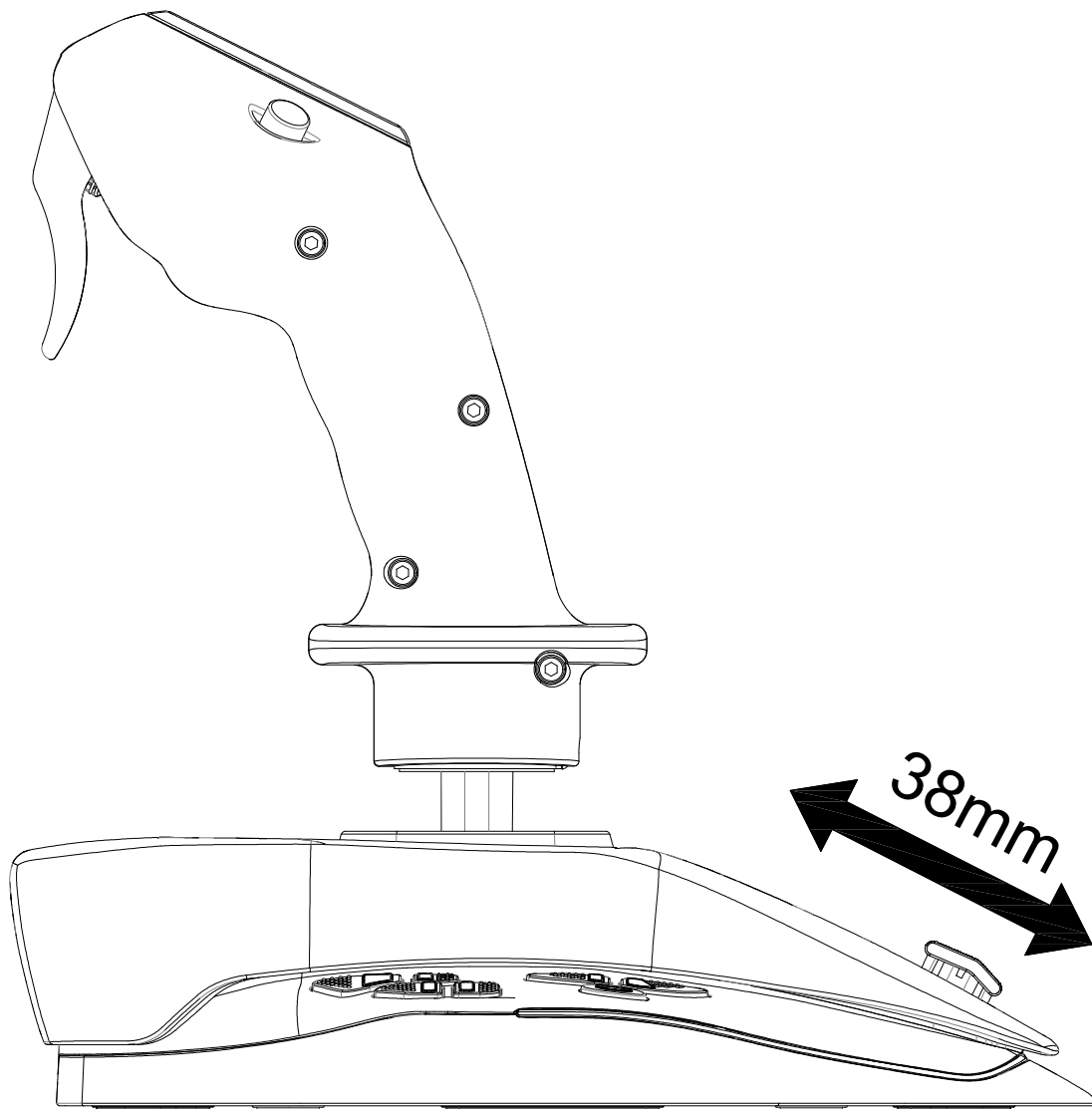

\*Potentiometer Axis Available Physical Travel: 38mm, Operation Force: 35-135gf

## 1.2 Applicable Models

For independent use

### 1.3 Dimensions

L\*W\*H: 227mm\*217mm\*230mm

Weight: 0.98Kg=2.16lb

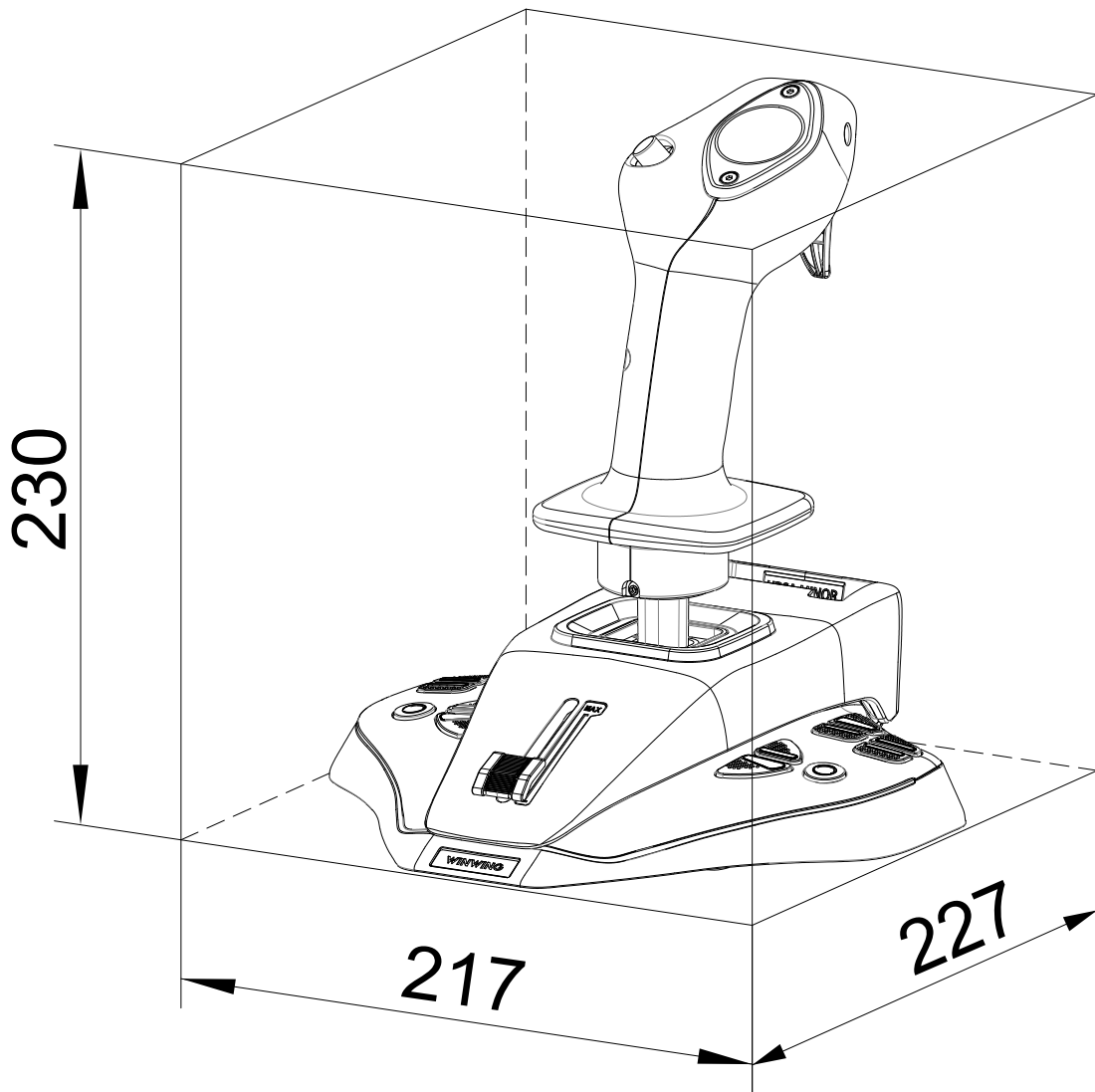

## 1.4 Installation Dimensions

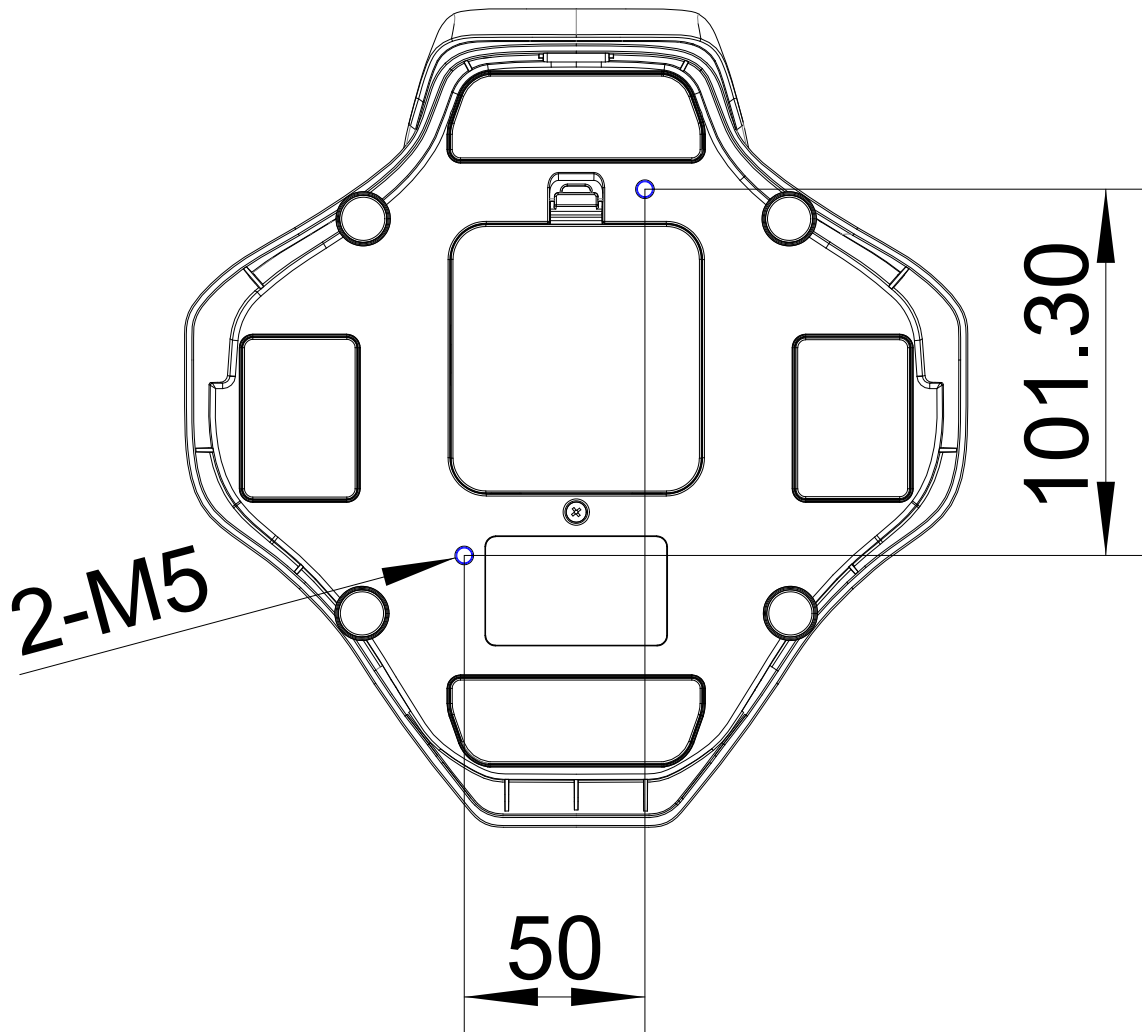

Note: The screw insertion depth must be greater than 6mm and less than 10mm. Screws must be self-prepared and are not included in the accessory kit.

\* Unit: mm

## 2 Functions

### 2.1 Buttons and Functions

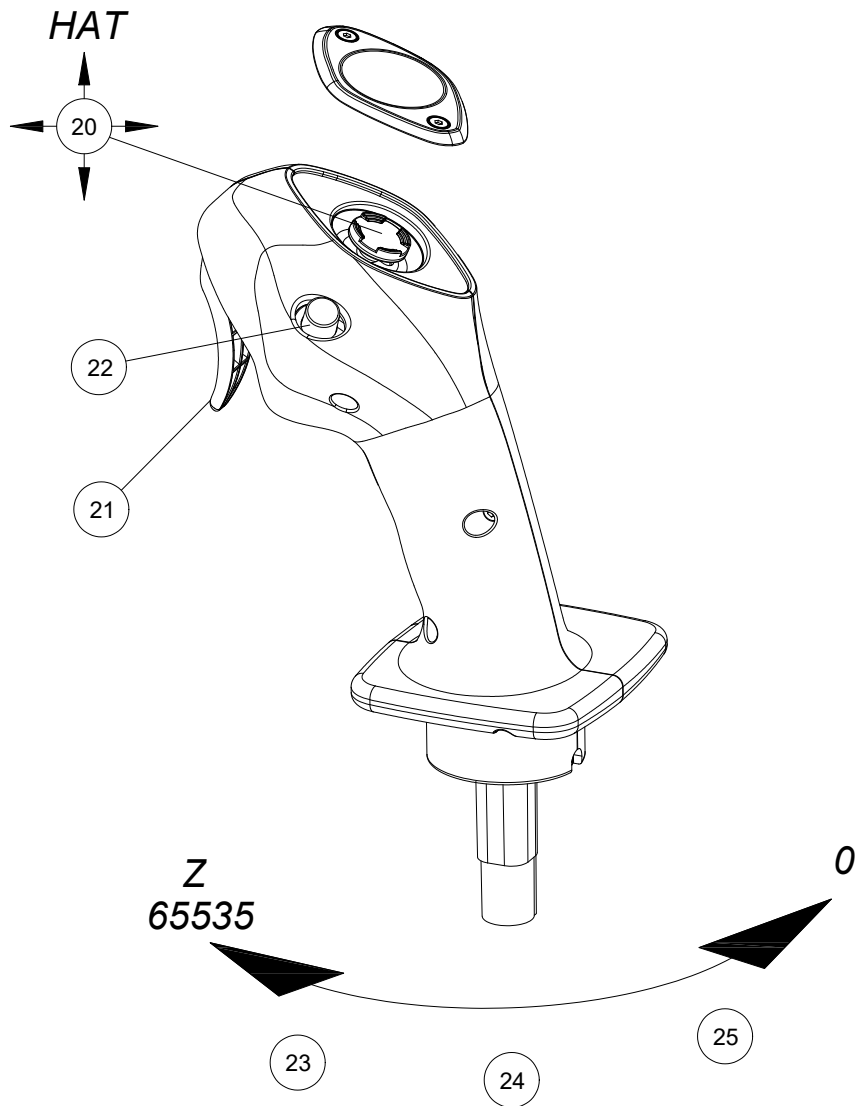

\* \* The multifunction switch (Key 20) has an actuation force of approximately (250  $\pm$ 100) gf. The maximum actuation force the switch can withstand is 400 gf; exceeding this force may result in switch damage.

\*The grip is equipped with vibration function, with adjustable vibration intensity levels from 0 to 255.

\* Removing the magnetic cover reveals the hidden 5-way switch.

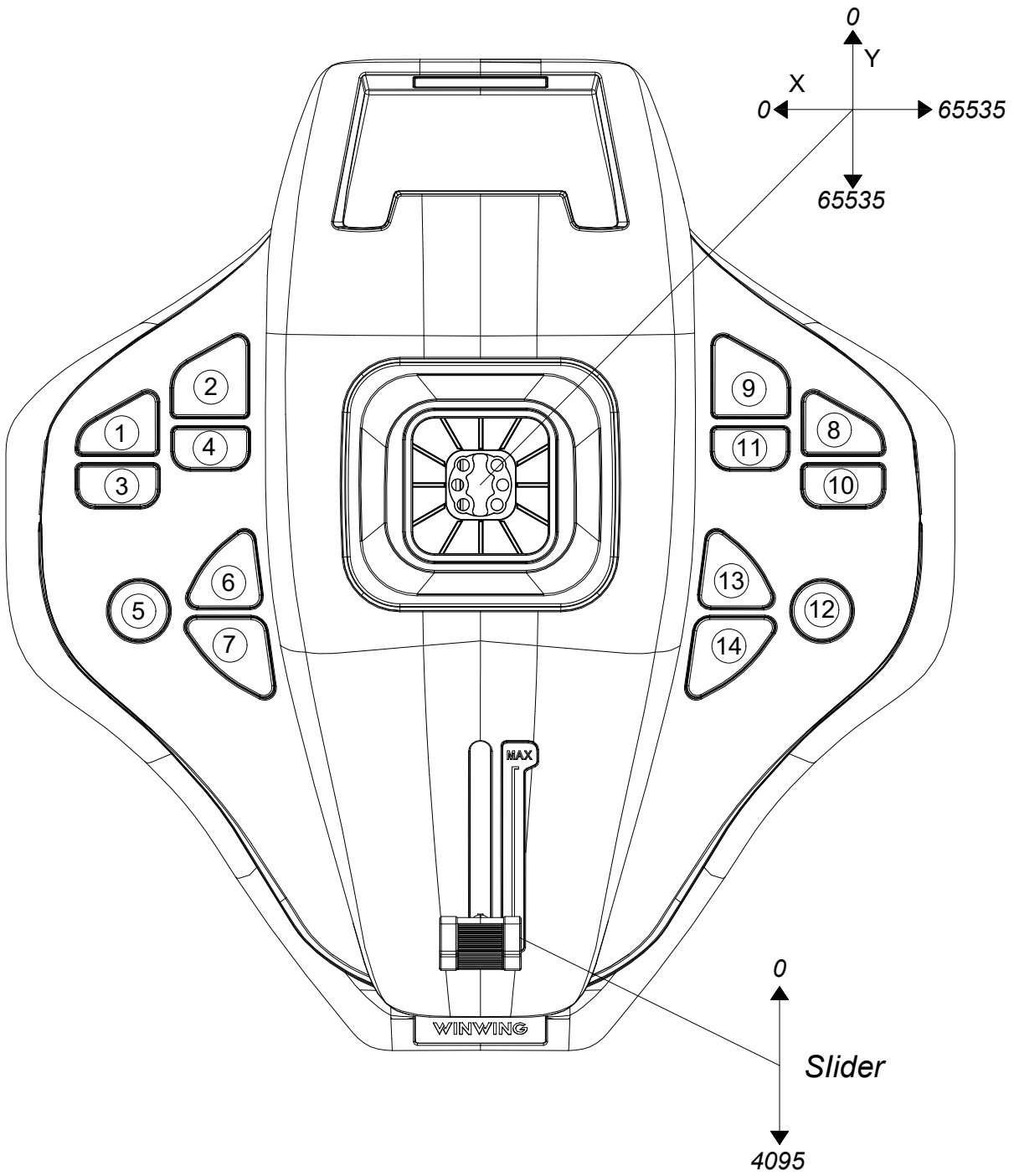

\*14 Button Switches: Press Force of 250gf, Press Travel of 0.25mm.  
 Note: Please press the center area of the keycap. Pressing too close to the edge may cause the keycap to get stuck.

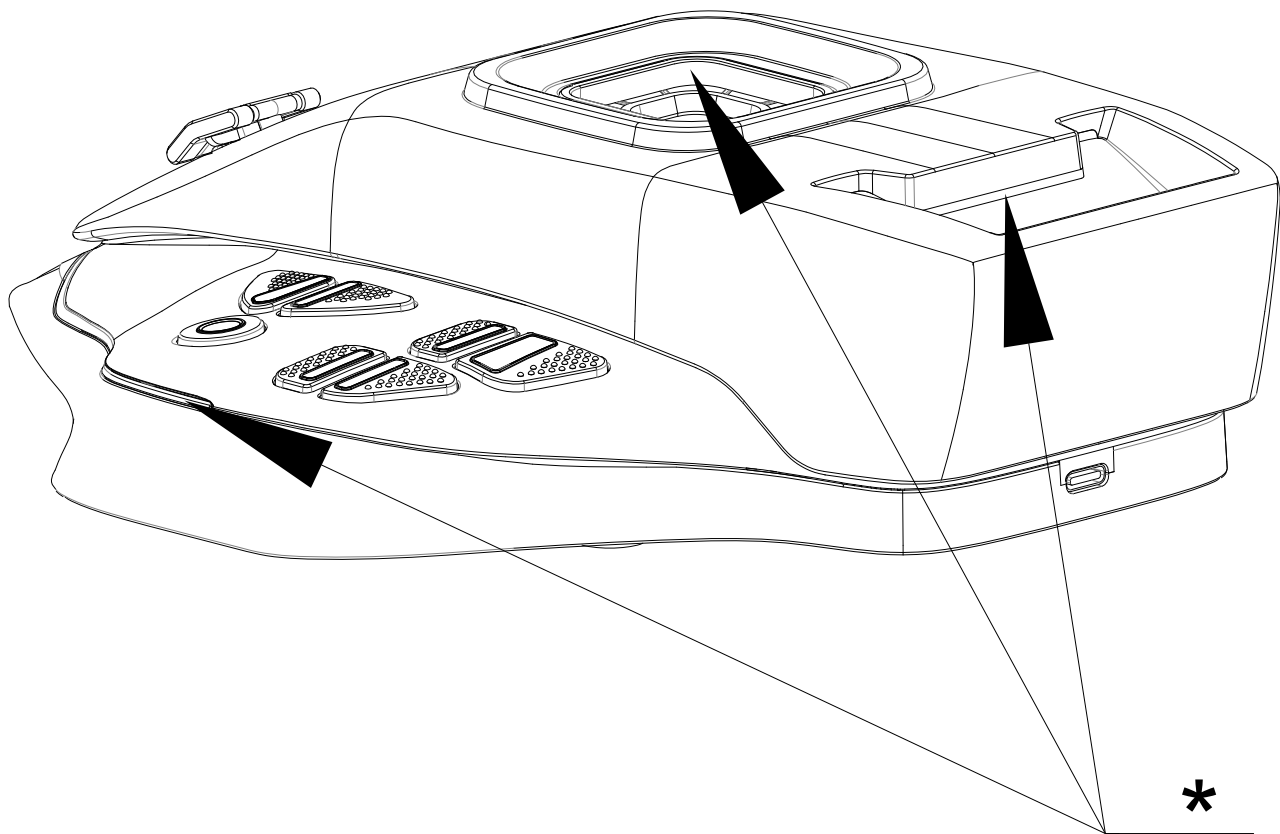

\* Ambient Light: 1 cold white light path

① Logic in compatible status: In upgrade mode, it cycles on and off (on for 1 second, off for 1 second). In work mode, it flashes (on for 1 second, off for 1 second) 5 times after power on, then controlled by SimAppPro, and the status light goes out after the computer enters sleep mode.

② It can also be configured as a breathing light mode in SimAppPro, gradually brightening from dark to the brightest, then gradually dimming from the brightest to off, and it will continue to cycle in this way.

## 2.2 Adjustment Methods

### Z Axis Locking:

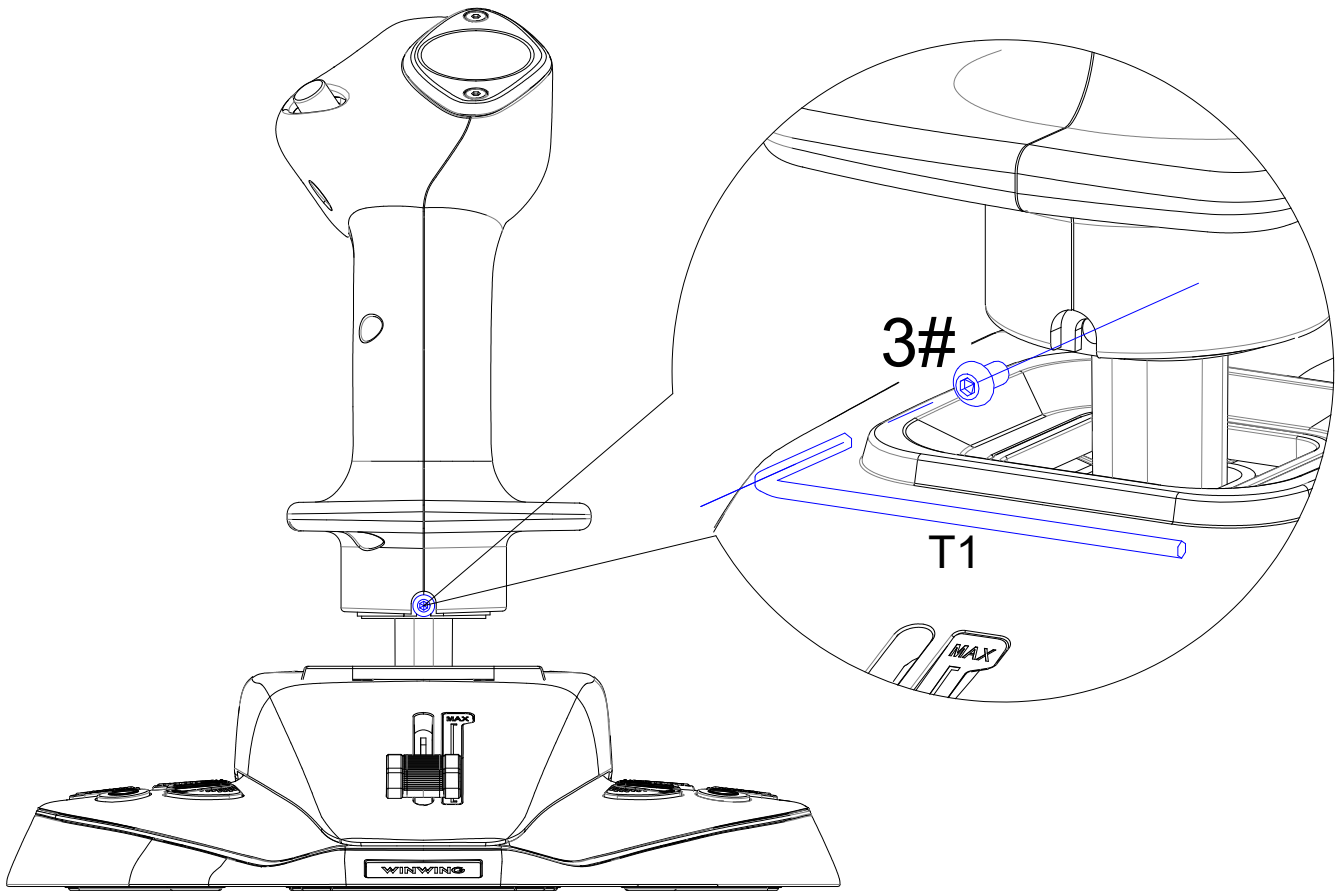

\*Z-axis is adjustable: With a T1 (2.0mm) hex wrench, tighten the screw to lock the Z-axis, and remove the screw to achieve Z-axis rotation of  $\pm 20^\circ$ .

## X/Y Axis Damping Adjustment:

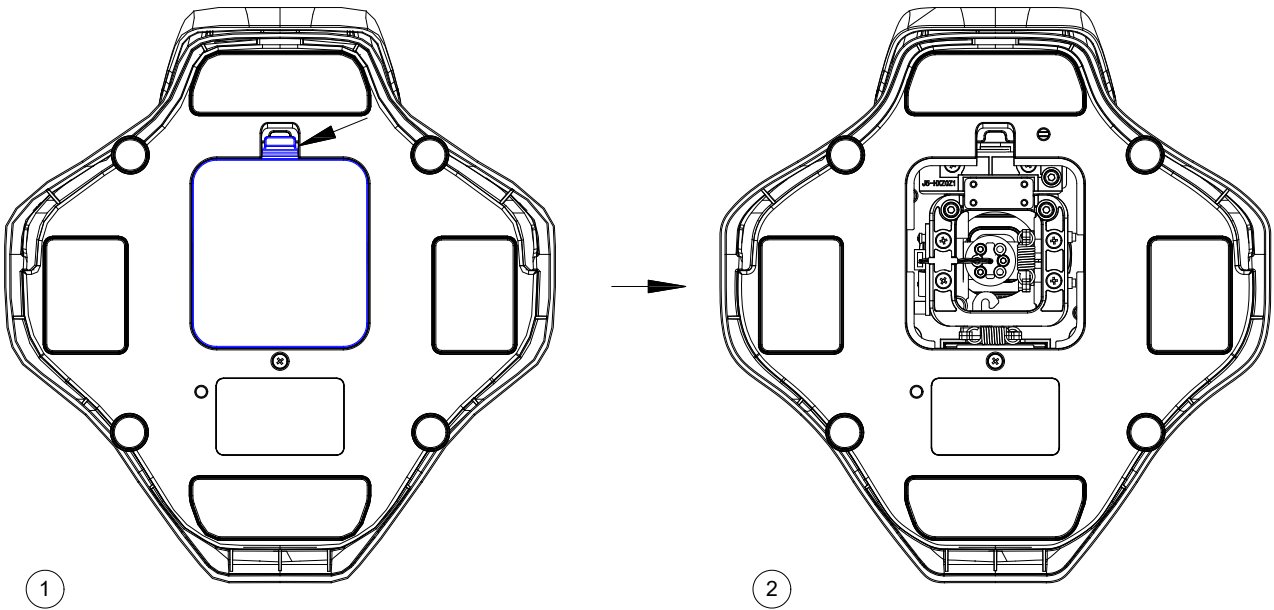

\* Flip the product to the bottom side, unfasten the clips and remove the bottom cover.

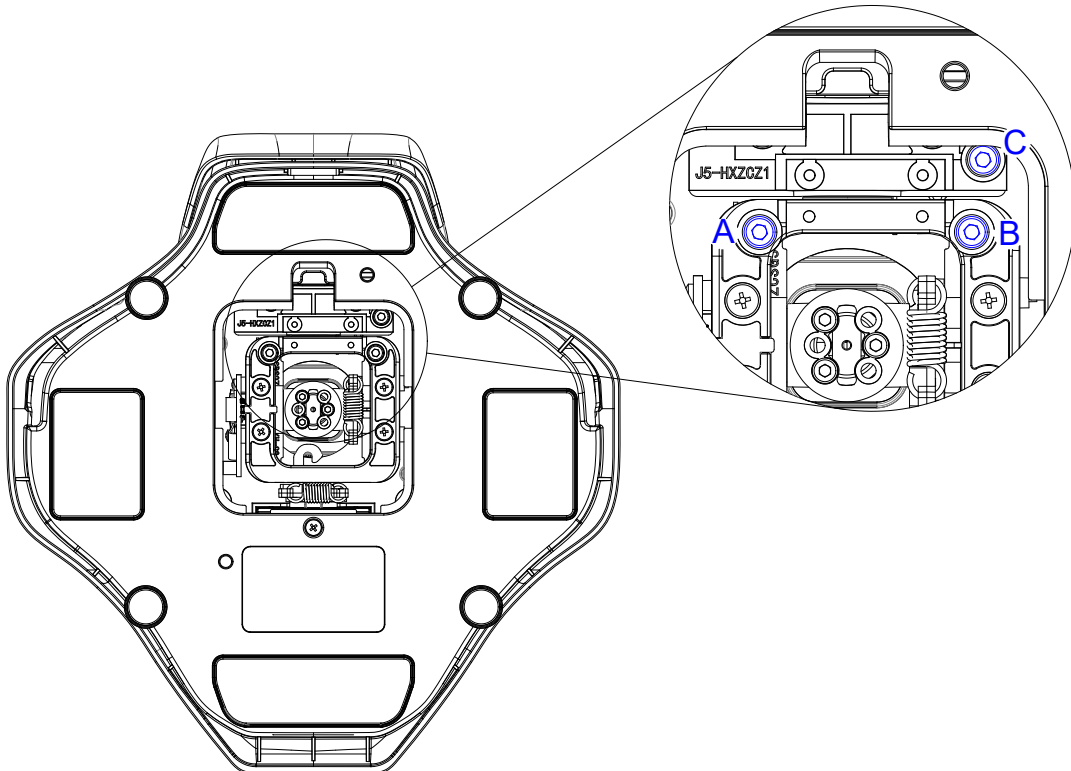

\*As shown, use T2 (2.5mm) hex wrench: Adjust screws A and B simultaneously to adjust X-axis damping (clockwise to increase, counterclockwise to decrease). Adjust screw C to adjust Y-axis damping (clockwise to increase, counterclockwise to decrease).

Note: Do not fully unscrew to prevent screw drop.

### 3 Components Assembly and Disassembly

/

### 4 Installation of Connectors

/

### 5 Installation Methods

#### 5.1 Desktop Mounting

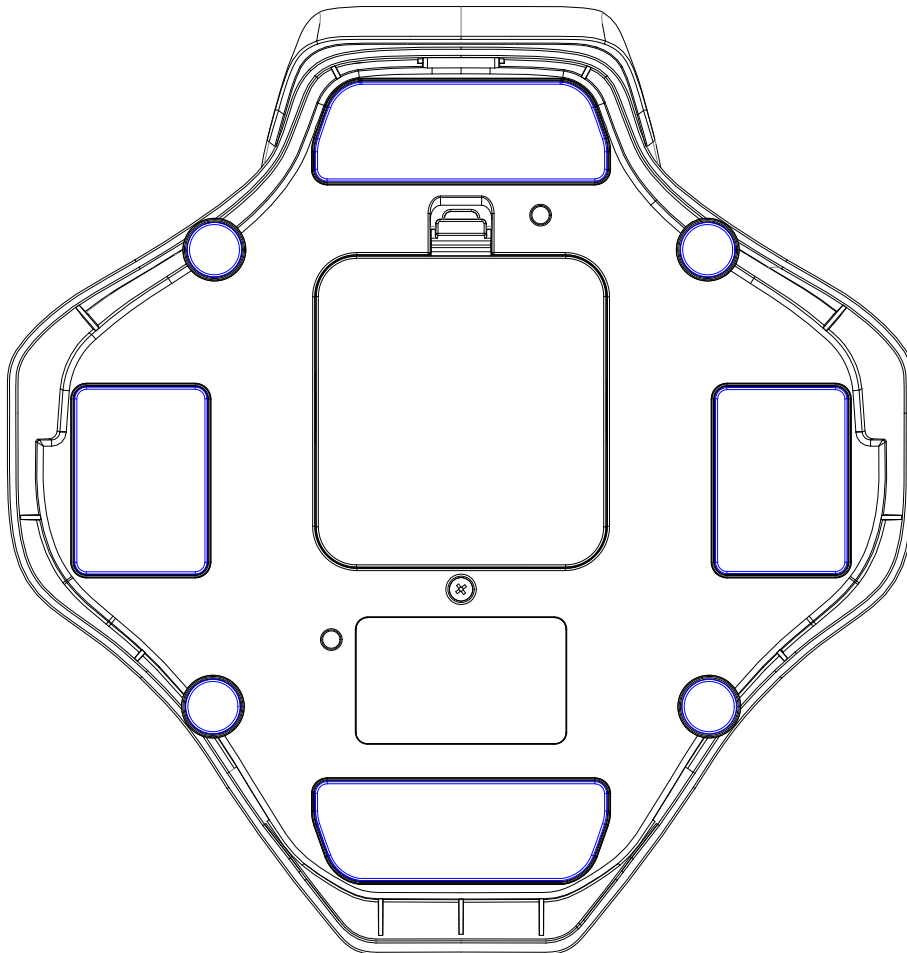

As shown, remove the protective film from the bottom silicone pad and place it directly on the desktop.

Note: Ensure the desktop is flat and clean. Glass and marble desktops provide better anti-slip effects.

Note: The shell of this product is made entirely of plastic, structured with 3 layers vertically stacked. After assembly and locking, due to the deformation and stacking of the plastic material, there may be a slight gap (gap MAX: 0.5mm) between the silicone foot pads at the bottom of the product and the placement surface. This does not affect usability.



## 5.2 Game Seat Mounting

\* Use two M5 screws to fix the product to a flat surface with holes from the bottom. Installation holes are shown in section 1.4 Installation Dimensions.

Note: Screw insertion depth should be greater than 6mm but less than 10mm. Screws must be self-prepared and are not included in the accessory kit.

## 5.3 Cascading

/

## 6 Calibration

### 6.1 X and Y Axes Joystick Calibration

①Open SimAppPro, click the device icon to enter the test page, then click the "Calibration" option;

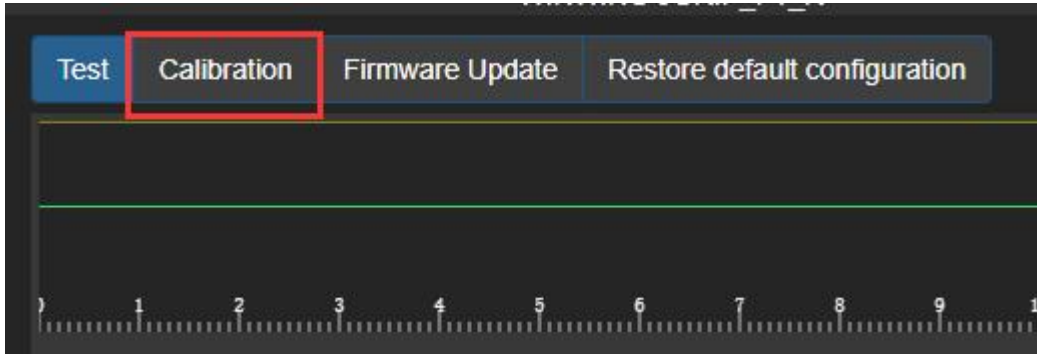

②On the calibration page, click the two buttons below to start calibration, then move the joystick through its full range;

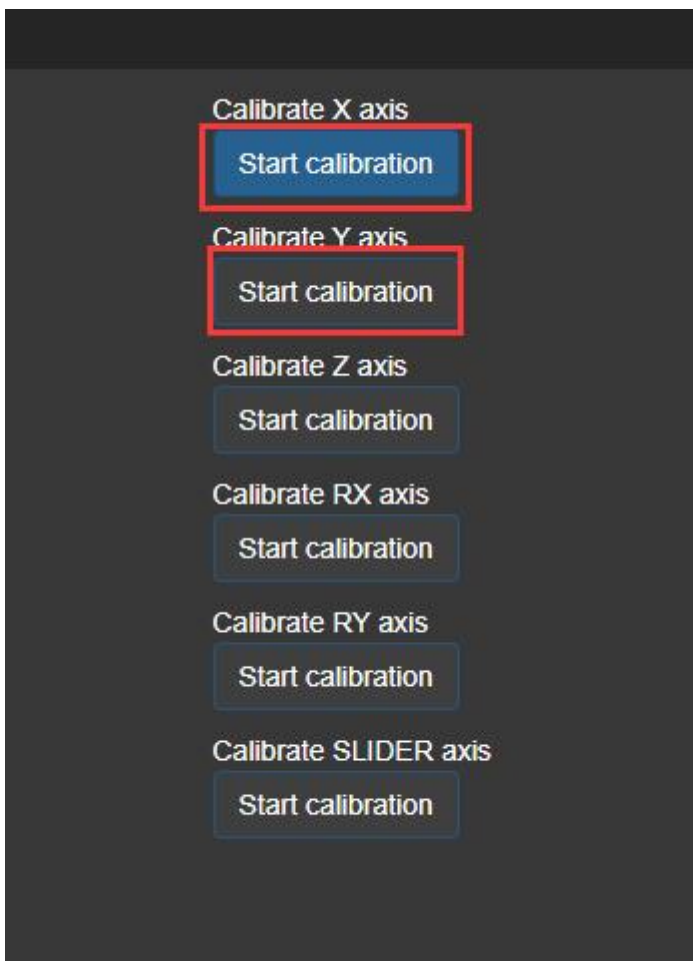

③After moving, let the joystick naturally return to the center, then click the two buttons below;

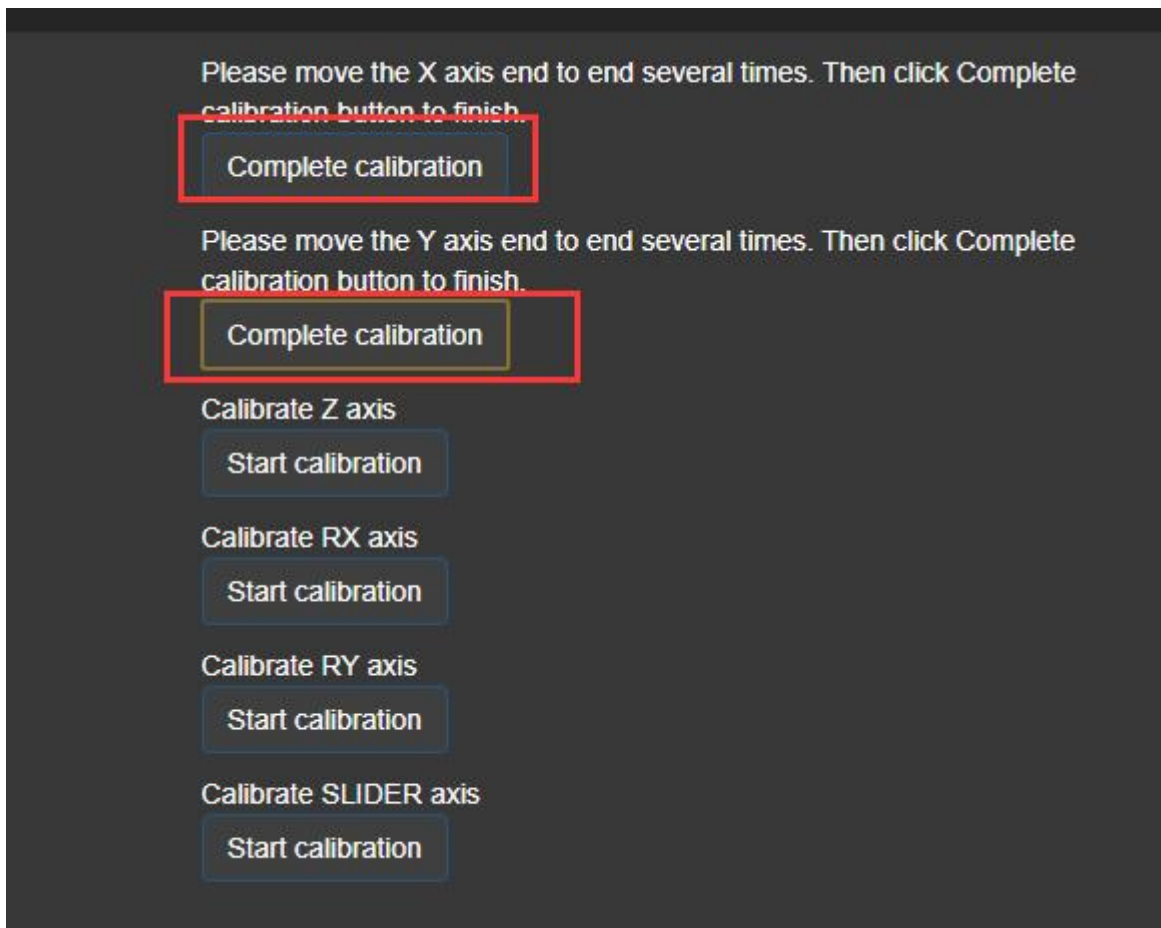

④At this point, the joystick calibration is complete. Return to the test page and observe if the data is normal. If there are abnormalities, please re-execute the calibration steps.

## 6.2 Z Axis calibration

①Open SimAppPro, click the device icon to enter the test page, then click the "Calibration" option;

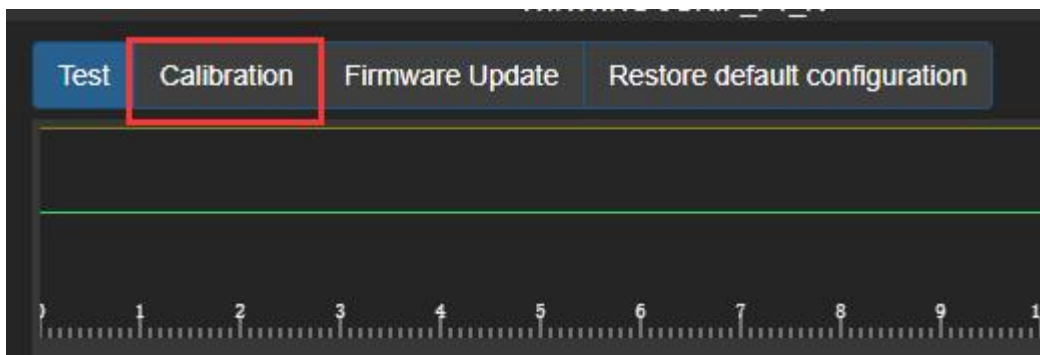

②

On the calibration page, click the button below to start calibration, then rotate the Z-axis through its full range;

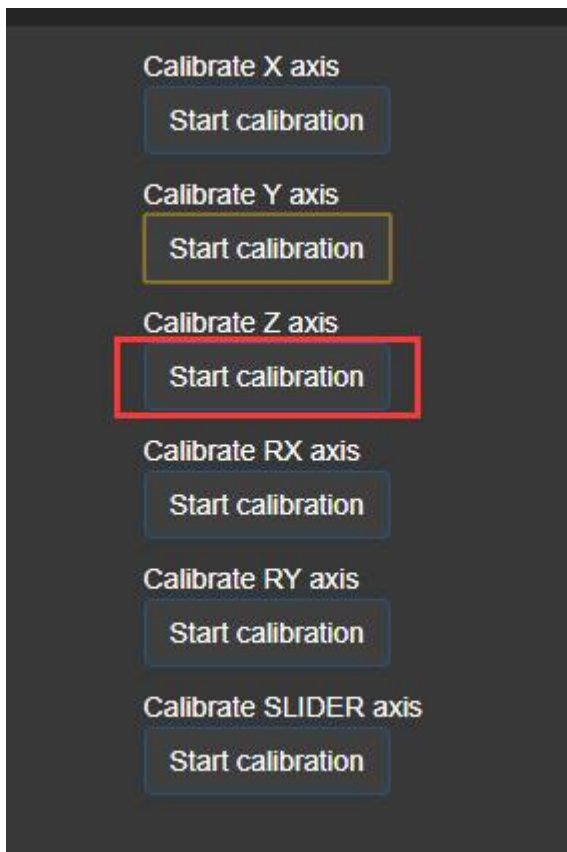

③After moving, let the Z-axis naturally return to center, then click the button below;

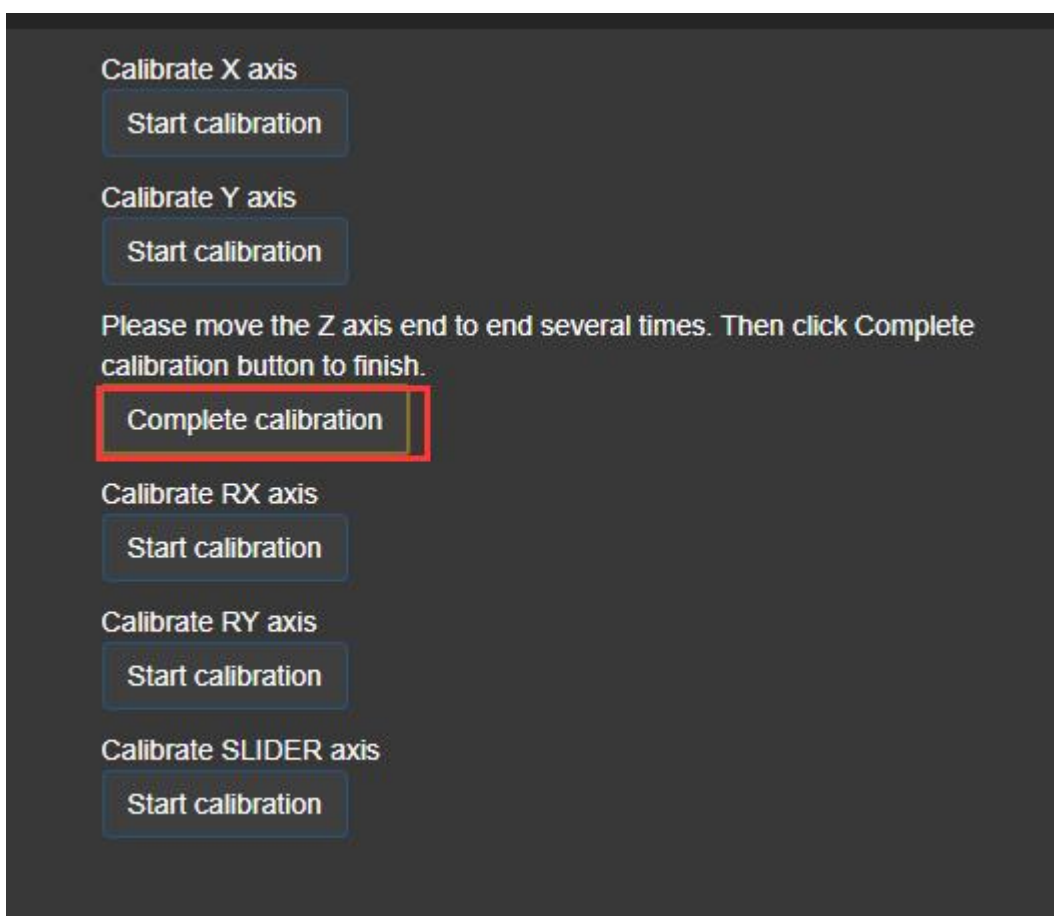

④At this point, the Z-axis calibration is complete. Return to the test page and observe if the data is normal. If there are abnormalities, please re-execute the calibration steps.

## 6.3 Slider Axis Calibration

①Open SimAppPro, click the device icon to enter the test page, and then click the “calibration” option;

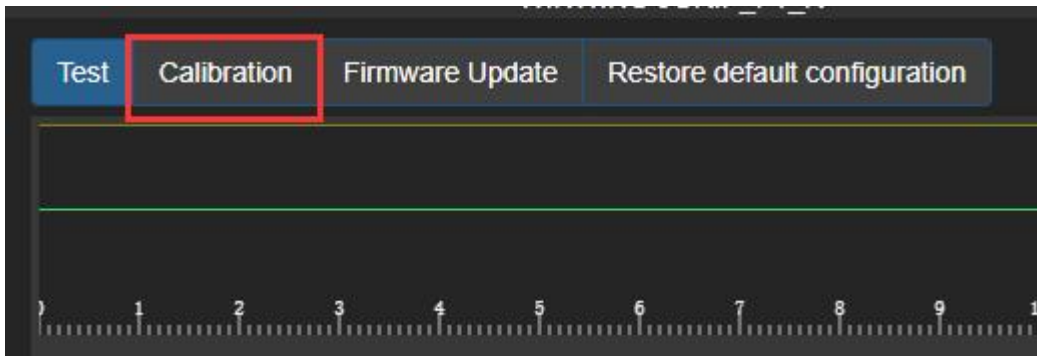

②On the calibration page, click the button below to start calibration, then move the slider axis through its full range;

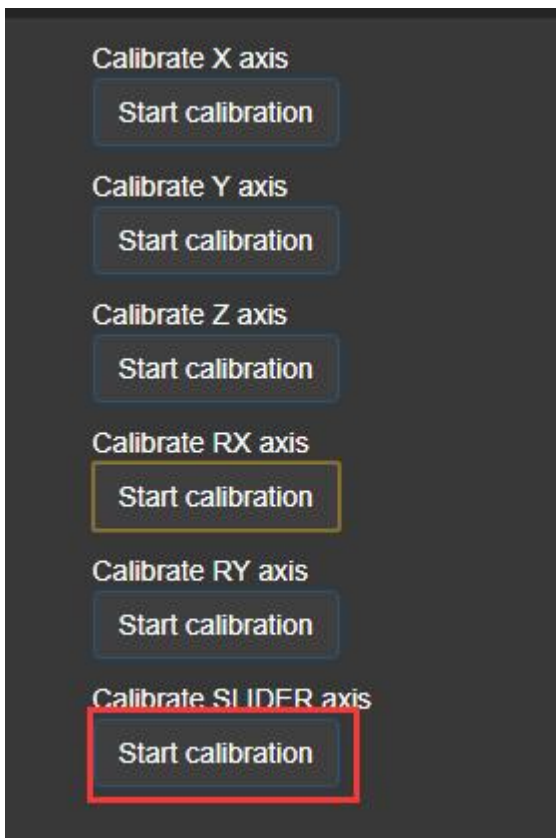

③After moving, click the button below;

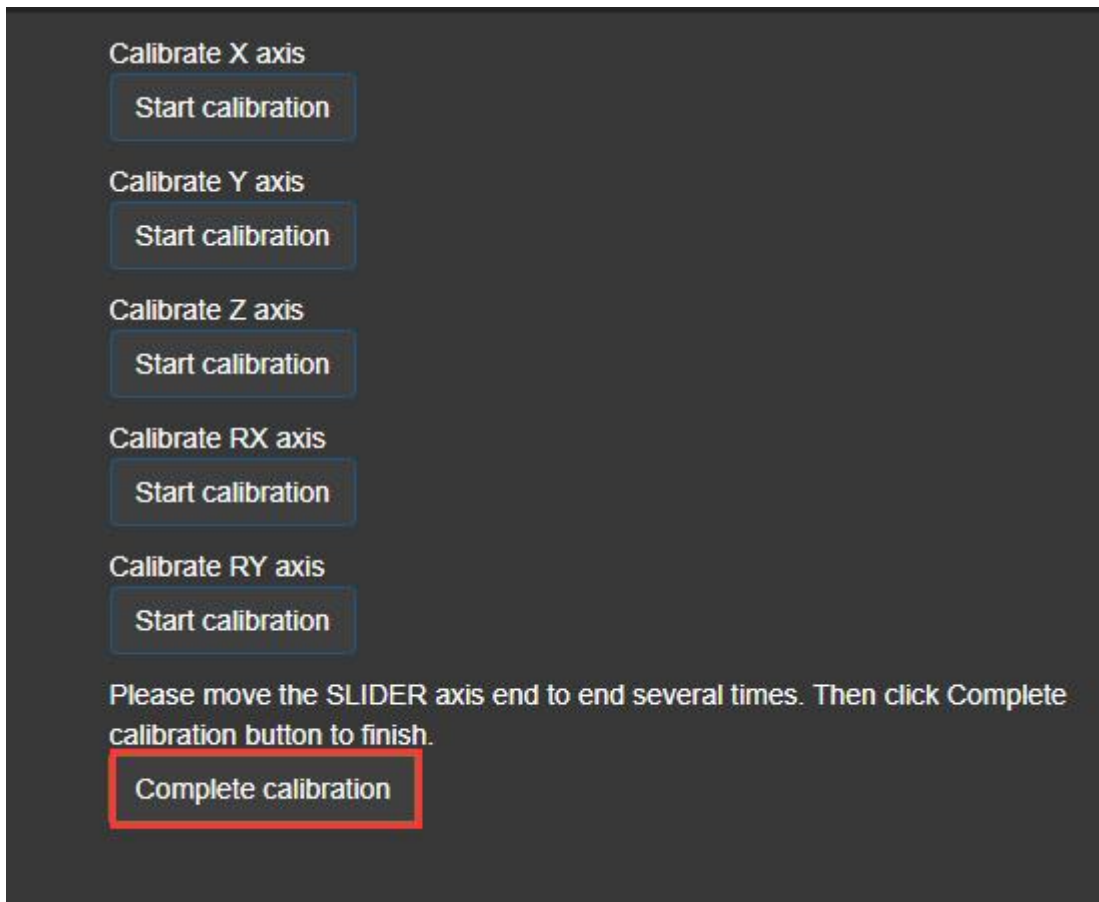

④ At this point, the slider axis calibration is complete. Return to the test page and observe if the data is normal. If there are abnormalities, please re-execute the calibration steps.

\*内容如有更新，恕不另行通知。

\*Contents are subject to updating without notice.

# 成都翼胜科技有限责任公司

WWW.WINWING.CN

INFO@WINWING.CN

成都市郫都区现代工业港长生桥路 1111 号 19 栋

High-tech International Enterprise Zone No.19 Building, Changshengqiao Road

1111#, Pidu District, Chengdu, Sichuan, China 610000